

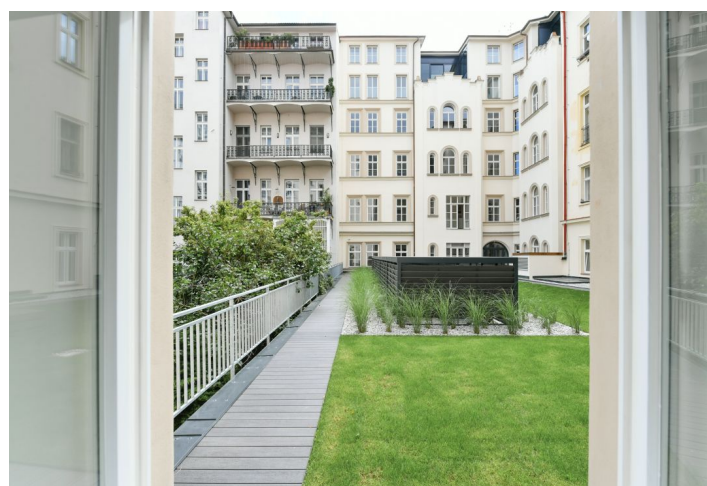

Apartment Three-bedroom (4+kk)

Rented

166 m², Prague 5, Malá Strana, Zborovská





Apartment Three-bedroom (4+kk)

Rented

166 m², Prague 5, Malá Strana, Zborovská

Total area	166 m²
Parking	On-site garage parking.
Garage	Yes
Cellar	Yes
Service price	Deposit for services and water CZK 130/m2/month. Gas and electricity - transferred to the tenant.
PENB	A
Reference number	36503
Available from	Immediately

High-standard apartment with parking. This completely refurbished 2-bathroom apartment is situated on the 1st floor of a late 19th century apartment building that has been meticulously renovated, benefiting from a 24/7 reception, security, camera system, swimming pool, sauna, gym, underground parking, an elevator, and a landscaped courtyard garden. Centrally located just steps from the Vltava riverbank, within walking distance of Kampa Island, Petřín Hill Park, Malá Strana (Lesser Town) and Old Town. The neighborhood has easy access to the Prague Castle, the Anděl commercial center and metro station, and the French School.

The interior features a large living room with a dining space and a fully fitted open kitchen, 3 bedrooms, 2 bathrooms, a utility room, an additional separate toilet, and a spacious entrance hall.

Smart home control and security system, quality equipment and finishes, **heat recovery ventilation**, **oak floors**, large-format tiling, security entry door, built-in wardrobes, triple-glazed windows, automatic roller blinds, gas boiler, washer, dryer, **SieMatic** kitchen with **Miele** appliances, induction cooktop, dishwasher, microwave oven, video entry phone, Wi-Fi, **cellar**, chip entry, charging station for electric cars. A **garage parking** space is available at CZK 10,000/month + VAT.

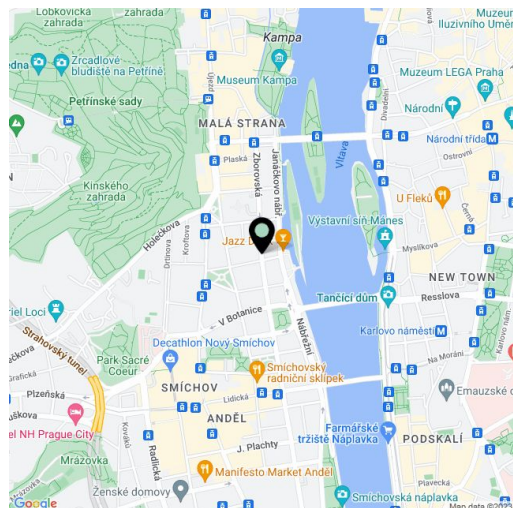

* Size of the unit according to the Housing Act.
The area consists of the sum total of the internal area of every room.

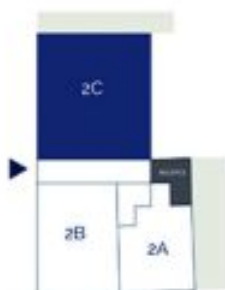

Apartment Three-bedroom (4+kk)

Rented166 m², Prague 5, Malá Strana, Zborovská

Celková výměra bytu	166 m ²
Vstupní hala	17 m ²
Chodba a šatna	12 m ²
WC	1 m ²
Technická místnost	3 m ²
Pracovna	15 m ²
Obývací pokoj s jídelnou	57 m ²
Ložnice	15 m ²
Koupelna + WC	4 m ²
Koupelna + WC	4 m ²
Ložnice	17 m ²
Kuchyně	17 m ²
Chodba	4 m ²