

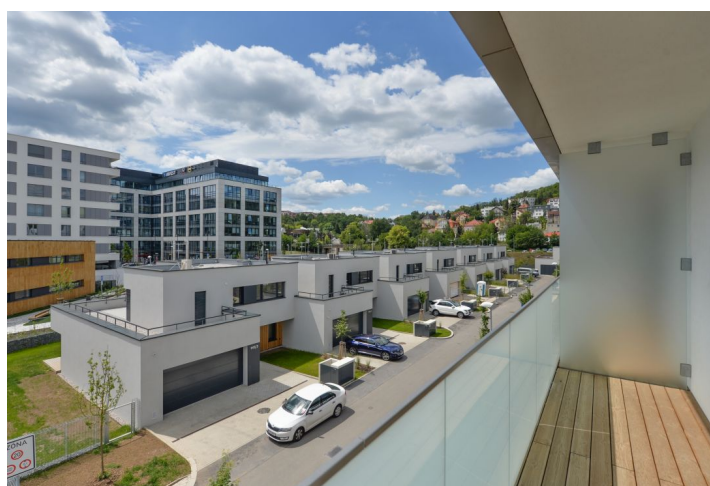

Apartment One-bedroom (2+kk)

Rented

58 m², Prague 5, Jinonice, Kloudova

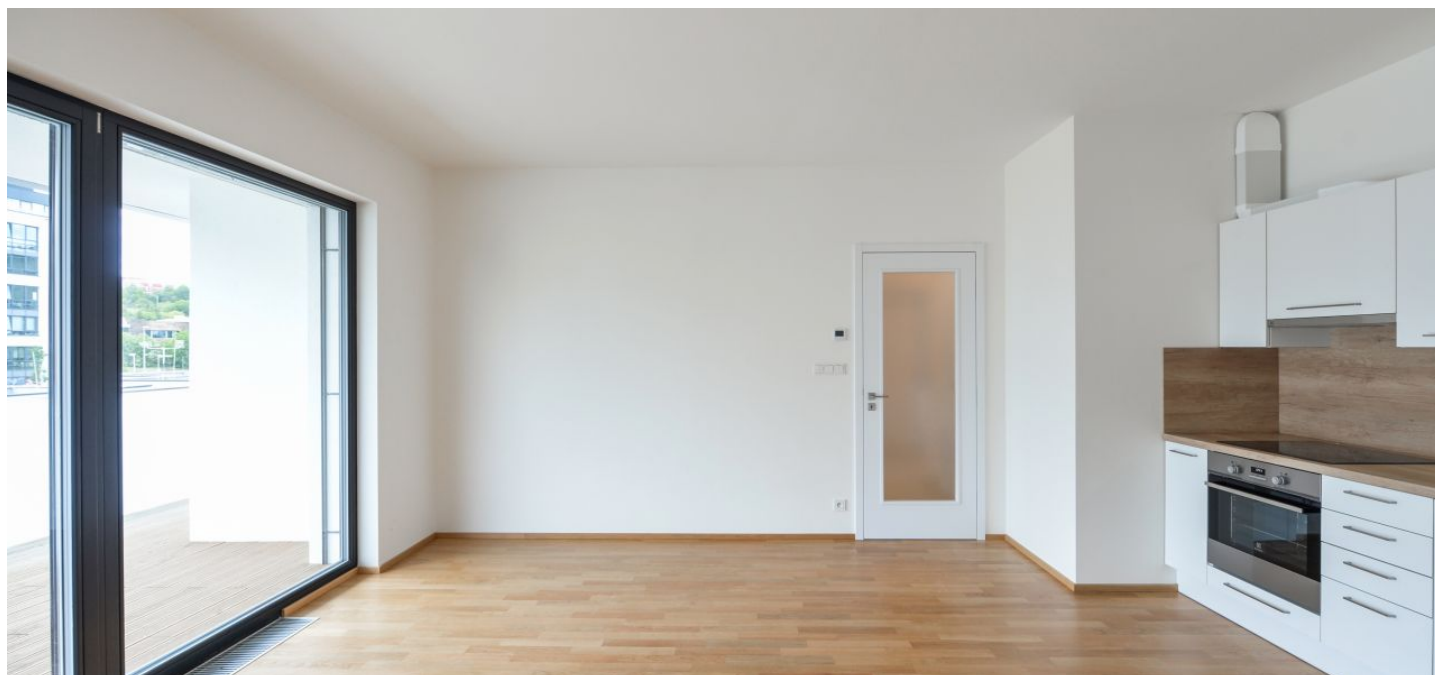



Apartment One-bedroom (2+kk)

Rented

58 m², Prague 5, Jinonice, Kloudova

Total area	76 m²
Floor area*	58 m²
Terrace	18 m²
Parking	Garage parking.
Garage	Yes
Cellar	Yes
Service price	Deposit for service charges, water and heating CZK 4,300/month. Electricity - transfer to the tenant.
PENB	A
Reference number	35995
Available from	Immediately

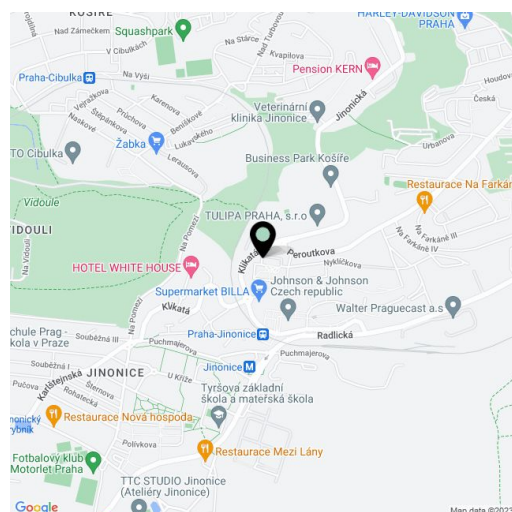

This is a contemporary 1-bedroom apartment in the Waltrovka project. Benefiting from an 18 m² terrace, the apartment is situated on the second floor in a new multi purpose residential project with underground parking and a variety of shops, services and restaurants. The project won the 2018 Real Estate Project of the Year award. It is located in a quiet green neighborhood with quick access to the city center, just a few min. walk from the Jinonice metro station. Conveniently located for the French and German international schools and the Anděl business district, within easy reach of green parks and multiple sports facilities including a golf course.

The interior features a living room with a dining area and a fully fitted open plan kitchen, a bedroom, a bathroom including a bathtub with a shower screen, a separate toilet, and an entrance hall with built-in wardrobes. The **terrace** is accessible from both the living room and the bedroom.

Hardwood floors, large format tiling, security entry door, oversized windows, automatic external blinds, central heating, dishwasher, induction cooktop, microwave oven, Villeroy & Boch bathroom fixtures, video entry phone, **cellar**, pram storage, bike wash room in the garage, chip entry. The apartment can be furnished at higher rent. An on-site **garage parking** space is included.

* Area of the unit according to the Civil Code. The area consists of the sum total area of the entire unit bounded by perimeter walls.