

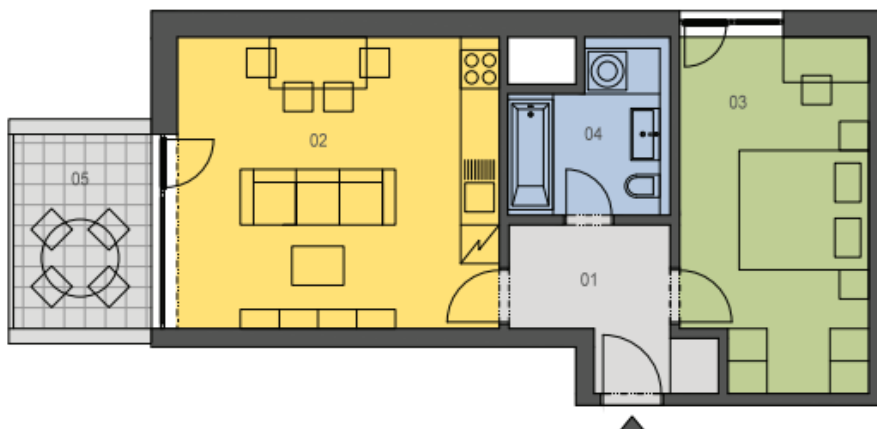

## Apartment One-bedroom (2+kk)

50 m², Prague 8, Libeň

**Sold**





## Apartment One-bedroom (2+kk)

**Sold**50 m<sup>2</sup>, Prague 8, Libeň

Total area	57 m <sup>2</sup>
Floor area*	50 m <sup>2</sup>
Balcony	7 m <sup>2</sup>
Parking	covered parking space
Garage	Yes
Cellar	Yes
PENB	G
Reference number	27044

\* Area of the unit according to the Civil Code. The area consists of the sum total area of the entire unit bounded by perimeter walls.

**Modern apartment with a west-facing balcony, part of a project of five low-floor, energy-saving villas close to the natural monument of Prosecké skály, along with good transport accessibility to the center.**

The apartment will be accessible through a sufficiently **large entry hall** with a niche for a built-in wardrobe and entrances to the **bedroom, bathroom and the living room with a kitchenette**. A French window in the living room will lead to a balcony overlooking the surrounding greenery.

Equipment will include **VILLEROY & BOCH, KALDEWEI, HÜPPE and HANSA** products in the bathrooms and **KÄHRS** wooden floors. The apartment price includes a **cellar and a covered parking space** accessible by elevator.

The residence is located at the end of a quiet street, close to the forest. Within walking distance there is a **bus and tram stop with direct links to the city center and the Palmovka and Kobylisy metro stations**. The Harfa Shopping Center and the Prague Multi-Arena with many sports and cultural events are nearby.

Completion scheduled for March 2018; future purchase contract succession.

Interior 50.2 m<sup>2</sup>, balcony 6.5 m<sup>2</sup>