

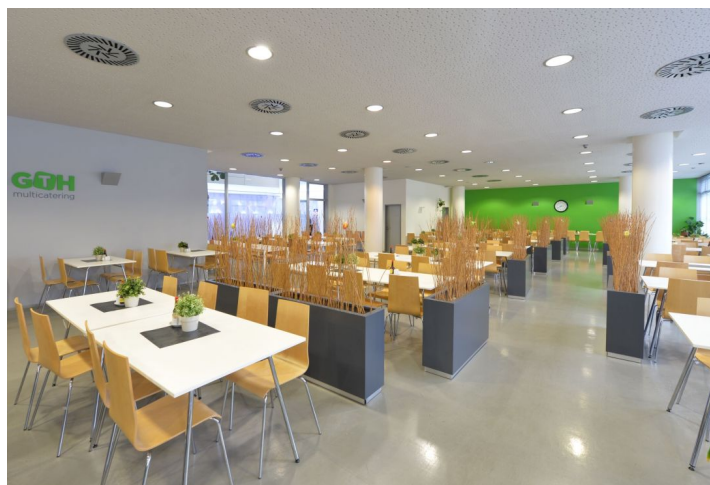

Office space

Prague 4, Michle, Vyskočilova

Ask for price

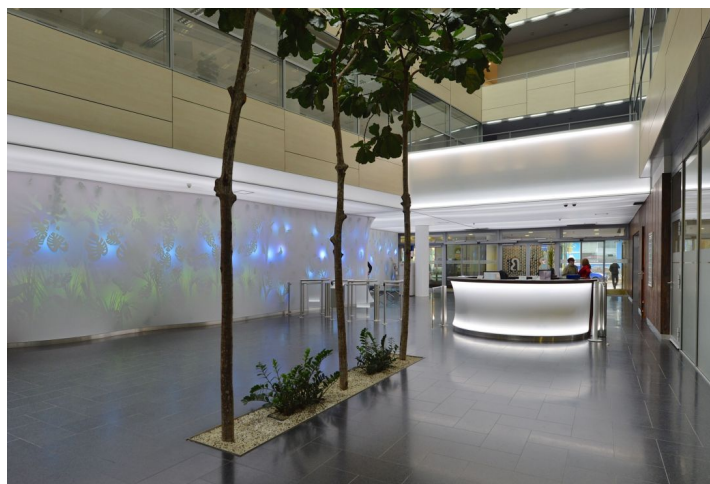



Office space

Prague 4, Michle, Vyskočilova

Ask for price

Available area	795 m ²
Cellar	-
Parking	EUR 125 / pp / month
PENB	D
Reference number	19738

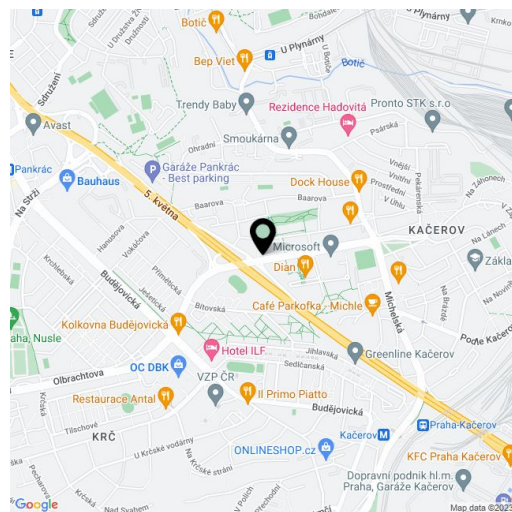

The modern office building, originating from the workshop of the architectural studio Aulík Fišer, offers the rental of quality Class A office space in Prague 4. These can be used as an open plan, separate office units or a combination of both options together. The building, completed in 2005, also offers all tenants a roof terrace accessible with excellent views of Prague. BREEAM certification at the Very Good level.

Location:

BB Centrum is situated in the location of Prague 4, one of the city's most developing business areas. This location is very easy accessible by public transportation. The Metro Station Budějovická, which runs on line C is linked by a complimentary shuttle bus service and is within 5 minutes walking distance from the building. There is also a bus station located directly in front of the building and it takes only one bus stop to reach the Budějovická metro station. The other advantage is the immediate connection to Prague's thoroughfare and also to the D1 Highway going in the direction of Brno, Budapest and Vienna. BB Centrum features its own fitness center, coffee shops, restaurants, a post office and a shopping center; a kindergarten is also currently being constructed, and a park is also in the making - all this and more makes BB Centrum one of the best business developments in Prague.

Features and Services:

Representative reception
CCTV and electronic security system
24/7 security service and access
Access card system
Modern elevators
Extensive Canteen
Café, restaurant, coffee shop and fitness center within BB Centrum
Roof terrace accessible to all tenants

Images might not accurately reflect the current state of the premises.

Rental and service charges listed without VAT. Lessee pays no commission.