

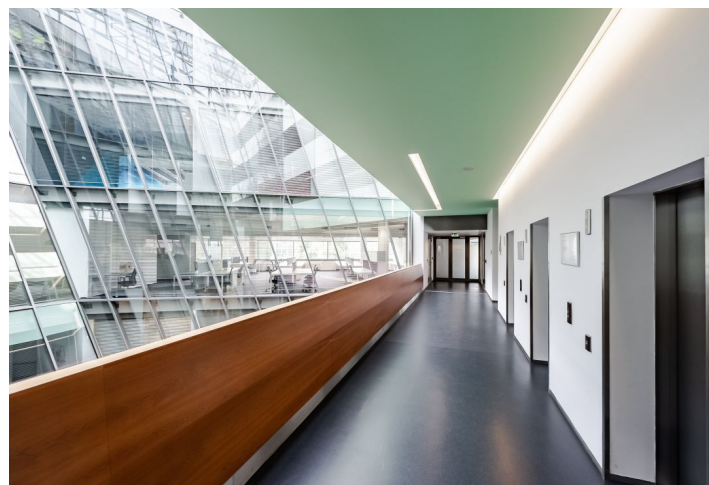

Office building

Prague 4, Michle, Vyskočilova

Rented

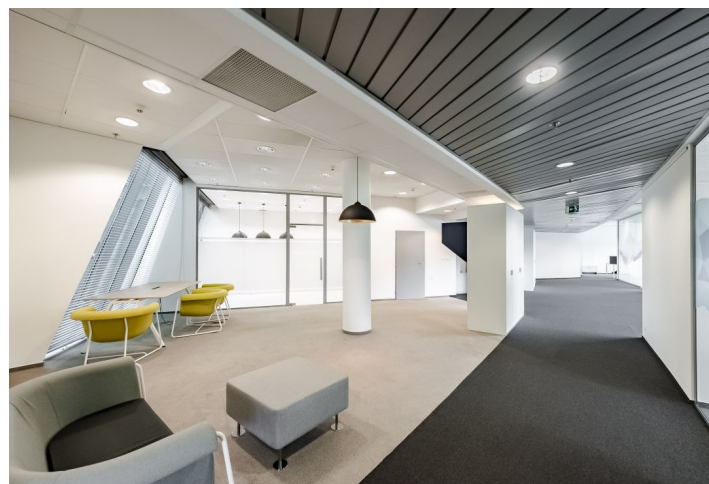
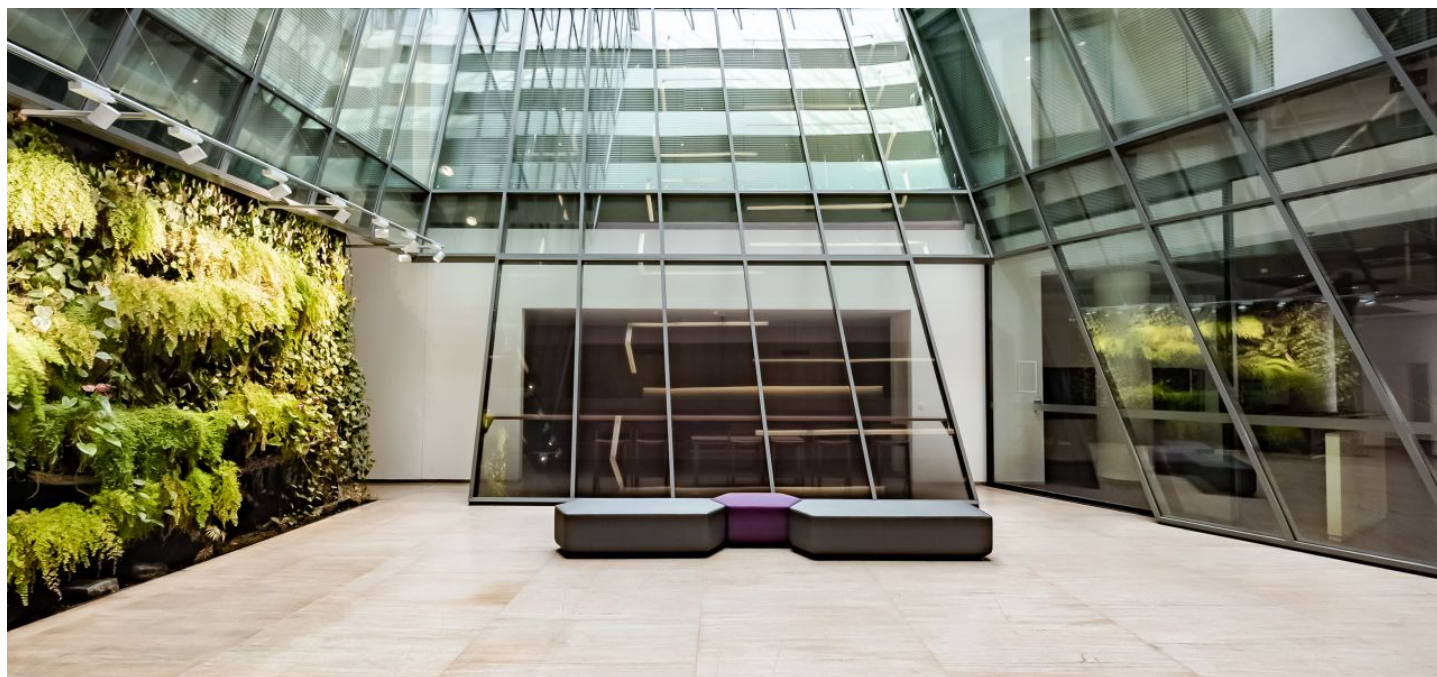

**Office building**

Prague 4, Michle, Vyskočilova

Rented

Service price	194 CZK monthly per m ²
Total building area	11 000 m ²
Tenant consumption	Consumption included in the service charges
Parking	Yes
Parking service charges	—
Parking ratio	—
Certification	—
PENB	C
Reference number	15445

Modern building with elegant design and architecture for demanding clients offering comfortable office space for rent in Prague 4.

High quality of office space for lease which can be used as an open-plan space, separate units or combination of both possibilities. The administrative building offers a canteen and roof top garden.

Location:

BB Centrum is situated in the location of Prague 4, one of the city's most developing business areas. This location is very easy accessible by public transport. The Budejovicka metro station, which runs on the C Line is linked by a complimentary shuttle bus service and is within 5 minutes' walking distance from the building. There is also a bus stop located directly in front of the building (only one bus stop to the Budejovicka metro station). Another big advantage is the immediate connection to Prague's thoroughfare and also to the highway D1 going to Brno, Budapest and Vienna. BB Centrum is like a small city within a city with its own fitness center, coffee shops, restaurants, post office, shopping center and kindergarten, a park with greenery, making it the most contained special business development in Prague.

Features and Services:

Representative reception
 CCTV and electronic security system
 24/7 security service and access
 Access card system
 Modern elevators
 Extensive Canteen
 Café, restaurant, coffee shop and fitness center within BB Centrum
 Excellent visibility from the highway D1
 Fantastic rooftop tranquil garden

Rental and service charges listed without VAT. Lessee pays no commission.

**Office building**

Prague 4, Michle, Vyskočilova

Rented