

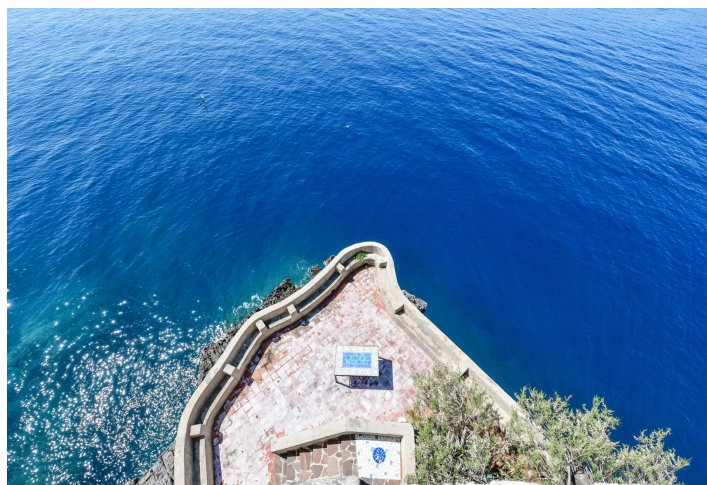

Historic property Four-bedroom (5+1)

Salerno, Amalfi Coast

Ask for price





Historic property Four-bedroom (5+1)

[Ask for price](#)

Salerno, Amalfi Coast

Total area	285 m ²
Foot print	155 m ²
Plot	6 400 m ²
Parking	-
PENB	G
Reference number	108287

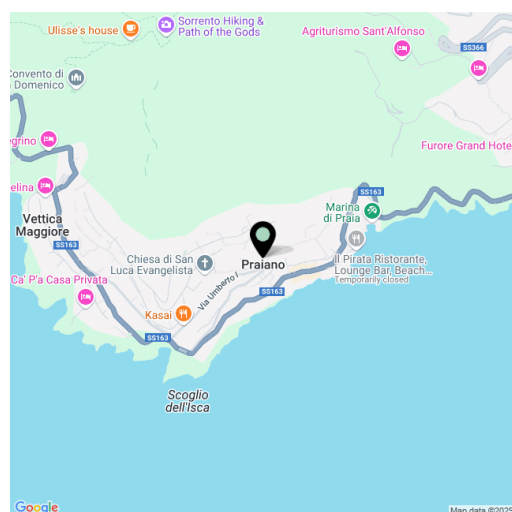

A 16th-century naval tower converted into a private two-story residence with sea access and panoramic terraces is located on a rocky promontory of the Amalfi Coast between the towns of Sorrento and Salerno.

On the ground floor there is the main living area with a dining room **overlooking the sea** and direct access to the lower **terrace**. There is also a kitchen, a room with a bathroom and an entrance hall with a staircase. The upper floor consists of a bedroom with an **en-suite bathroom**, 2 more bedrooms and a shared bathroom. Large arched windows lead to a semi-circular **panoramic terrace** with breathtaking views of the surrounding hills and the open sea. The property is complemented by an **outdoor dining room** with a barbecue and an underground storage room. Another storage space is located under the cliff at the entrance to the sea and is used to store beach and boat equipment.

The tower was used to defend the coast against pirate attacks in the 17th century. Today it is in good condition thanks to a series of conservative restoration works over the years. However, the building's technical systems require modernization. The 6,400 m² plot includes gardens, terraces and cliffs, and a large paved area can accommodate a helicopter.

The **Amalfi Coast** is one of the most beautiful destinations in Italy, famous for its dramatic cliffs overlooking the turquoise sea and picturesque villages. This **UNESCO-listed area** combines natural beauty, historical heritage and a refined lifestyle. The necessary services are available in the town 500 m away, the most important centers of the area (Positano, Maiori, Amalfi, Ravello, Sorrento) can be reached by car in less than an hour.

Floor area 155 m², terraces 55 m² and 40 m², cellar 35 m², plot 6,400 m².



Ref. 2117

TORRE DI GRADO

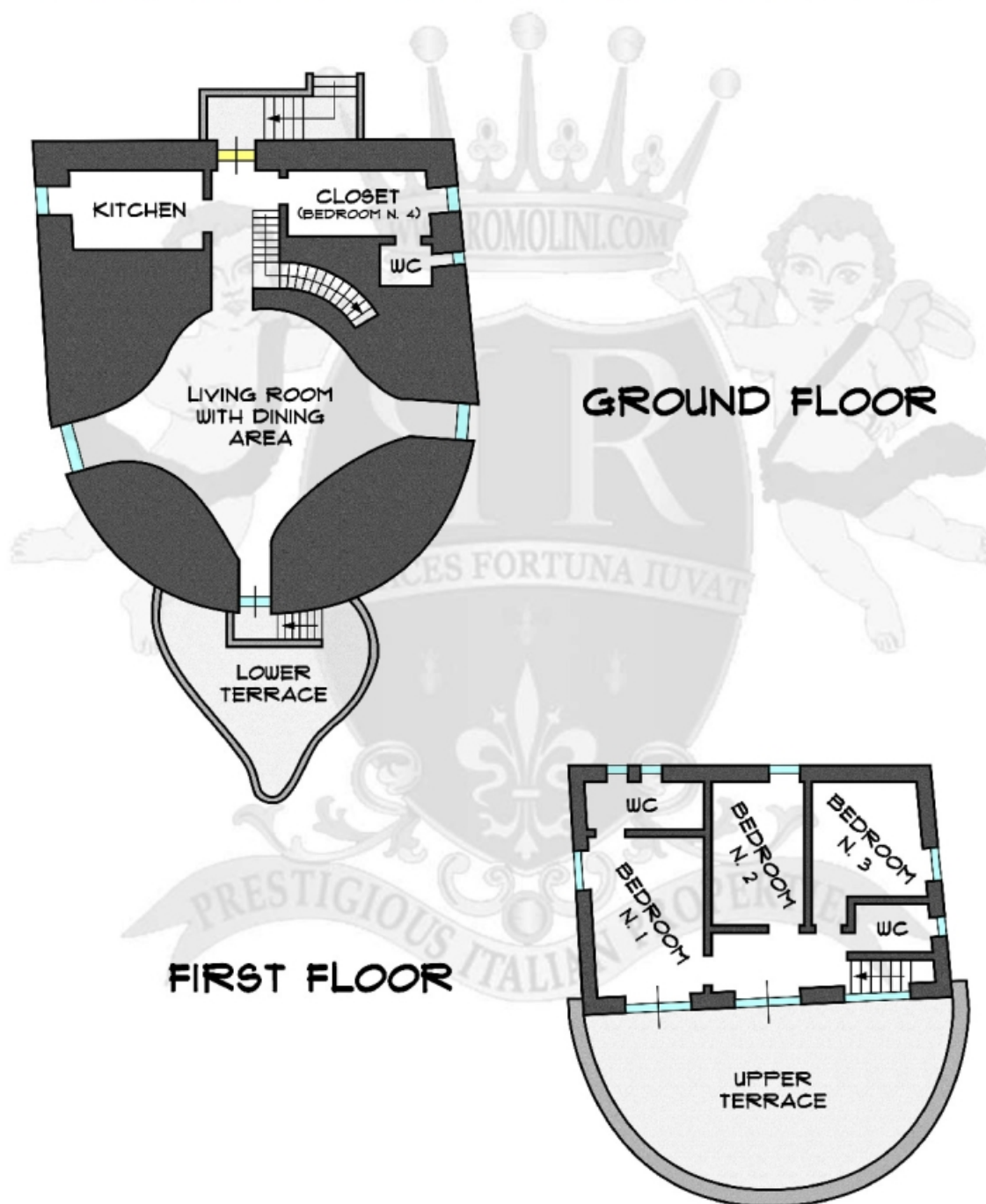



Historic property Four-bedroom (5+1)

Salerno, Amalfi Coast

Ask for price

