



Apartment Two-bedroom (3+1)

Sold

128.23 m², Prague 3, Žižkov, Malešická





Apartment Two-bedroom (3+1)

Sold128.23 m², Prague 3, Žižkov, Malešická

Total area	176 m ²
Floor area*	128 m ²
Terrace	48 m ²
Garden	98 m ²
Parking	2 garage parking spaces
Garage	Yes
Cellar	8 m ²
PENB	C
Reference number	105368

This modern air-conditioned duplex apartment with a terrace and garden is part of the gated Central Park Prague residential project with a private park, children's playground, 24/7 reception, security, and underground parking. The complex is adjacent to popular Parukářka Park in a quieter part of Prague 3 with complete civic amenities.

The entrance level on the 3rd floor consists of a living room with a work corner and a kitchen with a dining area. This entire connected space is glazed with access to a **covered terrace and roof garden**. There is also a separate toilet, a utility room with a connection for a washing machine and dryer, and an entrance hall with a staircase to the lower floor with a private area. It consists of a master bedroom with an **en-suite bathroom and walk-in wardrobe**, a second bedroom with a walk-in wardrobe, and a second bathroom. The apartment includes **2 garage parking spaces**, one of which is **extra-large**. There is also a spacious brick **cellar**.

The industrial character of the interior contrasts with wooden **floating floors** and interior doors, and **French windows** provide plenty of daylight. Heating is controlled centrally. The building is serviced by an elevator and secured by a **camera system**. Entry via a chip.

The area offers a wealth of social and sports activities, shops, restaurants, and a kindergarten, elementary and secondary school are within easy reach. Good transport accessibility to the city center is ensured by tram connections or the metro from the nearby **Želivského** station.

Floor area 128.23 m², terrace 47.58 m², garden 97.87 m², cellar 7.94 m².

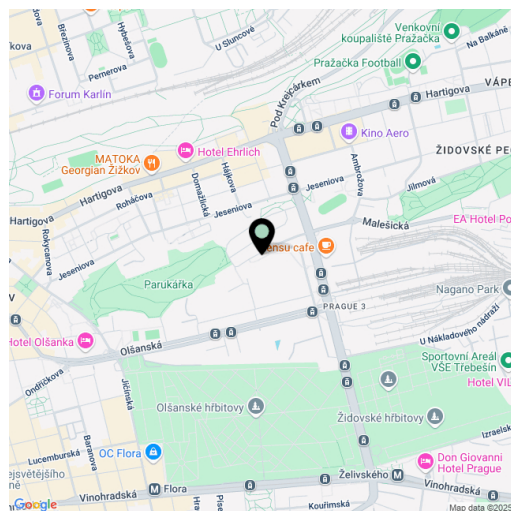

* Area of the unit according to the Civil Code. The area consists of the sum total area of the entire unit bounded by perimeter walls.

**Apartment Two-bedroom (3+1)****Sold**128.23 m², Prague 3, Žižkov, Malešická**JEDNOTKA / UNIT 451**

Byt / Flat

3+kk / 2-bedroom

Objekt / Building C5

Podlaží / Floor 3-4

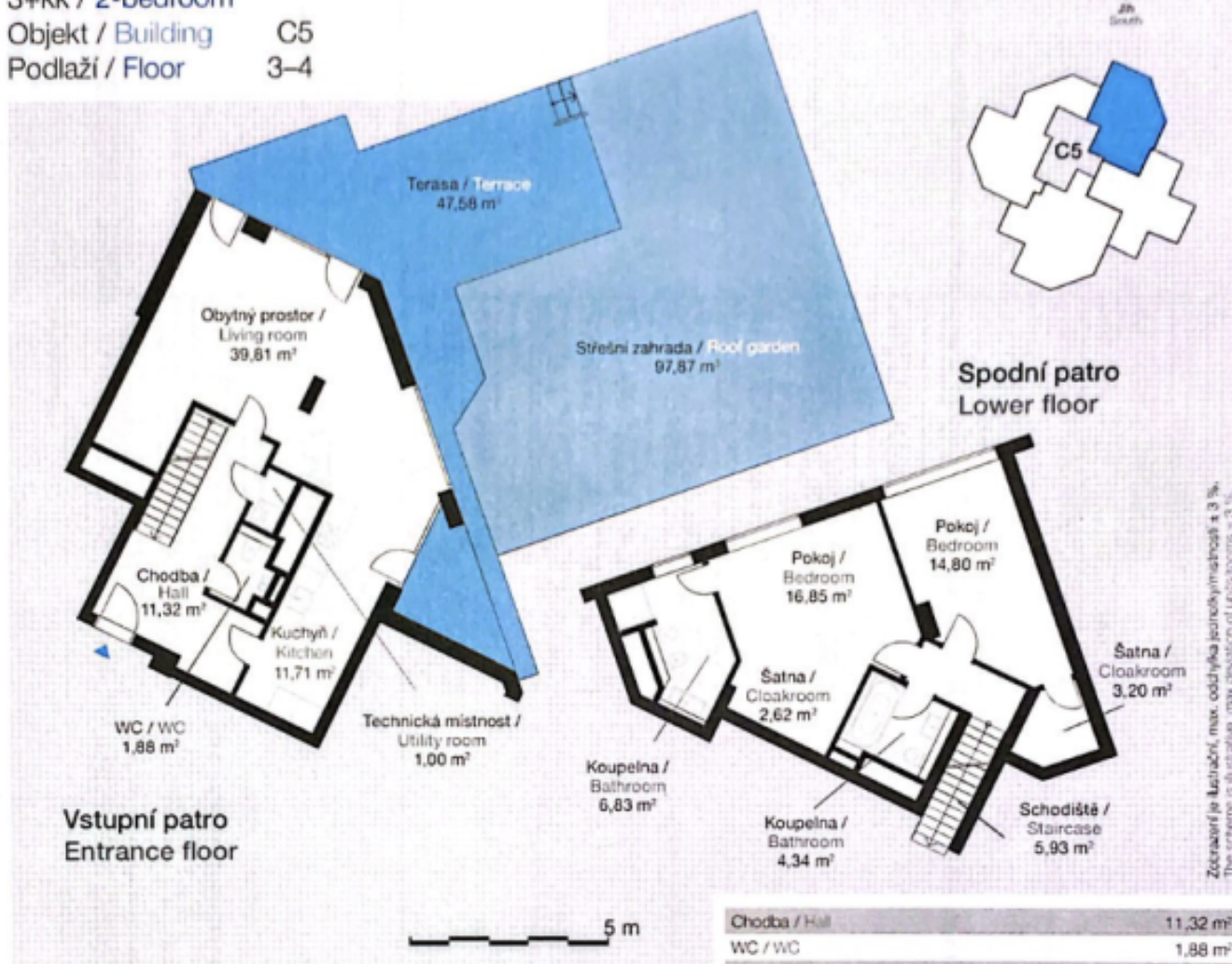

Chodba / Hall	11,32 m ²
WC / WC	1,88 m ²
Kuchyně / Kitchen	11,71 m ²
Obytný prostor / Living room	39,81 m ²
Technická místnost / Utility room	1,00 m ²
Schodiště / Staircase	5,93 m ²
Koupelna / Bathroom	4,34 m ²
Šatna / Cloakroom	3,20 m ²
Pokoj / Room	16,85 m ²
Koupelna / Bathroom	6,83 m ²
Pokoj / Room	14,80 m ²
Šatna / Cloakroom	2,62 m ²
Plocha bytu celkem / Living floor area total	120,29 m²
Terasa / Terrace	47,56 m ²
Sklep / Cellar	7,94 m ²
Střešní zahrada / Roof garden	97,87 m ²