

## Office space

Rented

Prague 8, Karlín, Křižíkova



## Office space

Rented

Prague 8, Karlín, Křížíkova

Service price	125 CZK monthly per m <sup>2</sup>
Available area	767 m <sup>2</sup>
Cellar	-
Parking	EUR 250 / pp / month
PENB	B
Reference number	39540

First-class office space for lease on the 4th floor in a new building with excellent transport accessibility near the Karlín Music Theater and the Museum of the Capital City of Prague. A shopping gallery, terrace, underground parking, and cultivated places to meet and relax are available in the building.

**Location:**

Excellent accessibility by public transport or car. Direct access from the Florenc metro station (line B, C), Florenc bus station, and tram connections. Also nearby are the Museum of the Capital City of Prague, the Karlín Music Theater, the Negrelli Viaduct, and the Masaryk Railway Station.

**Features and services:**

Underground parking  
Elegant reception

Rental and service charges are listed without VAT. Lessee pays no commission.

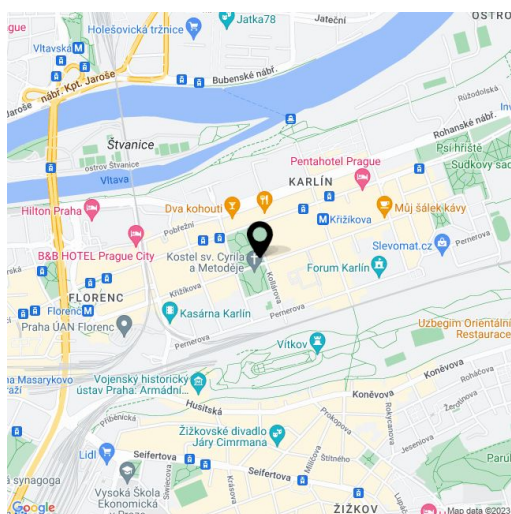

## Office space

Prague 8, Karlín, Křižíkova

Rented

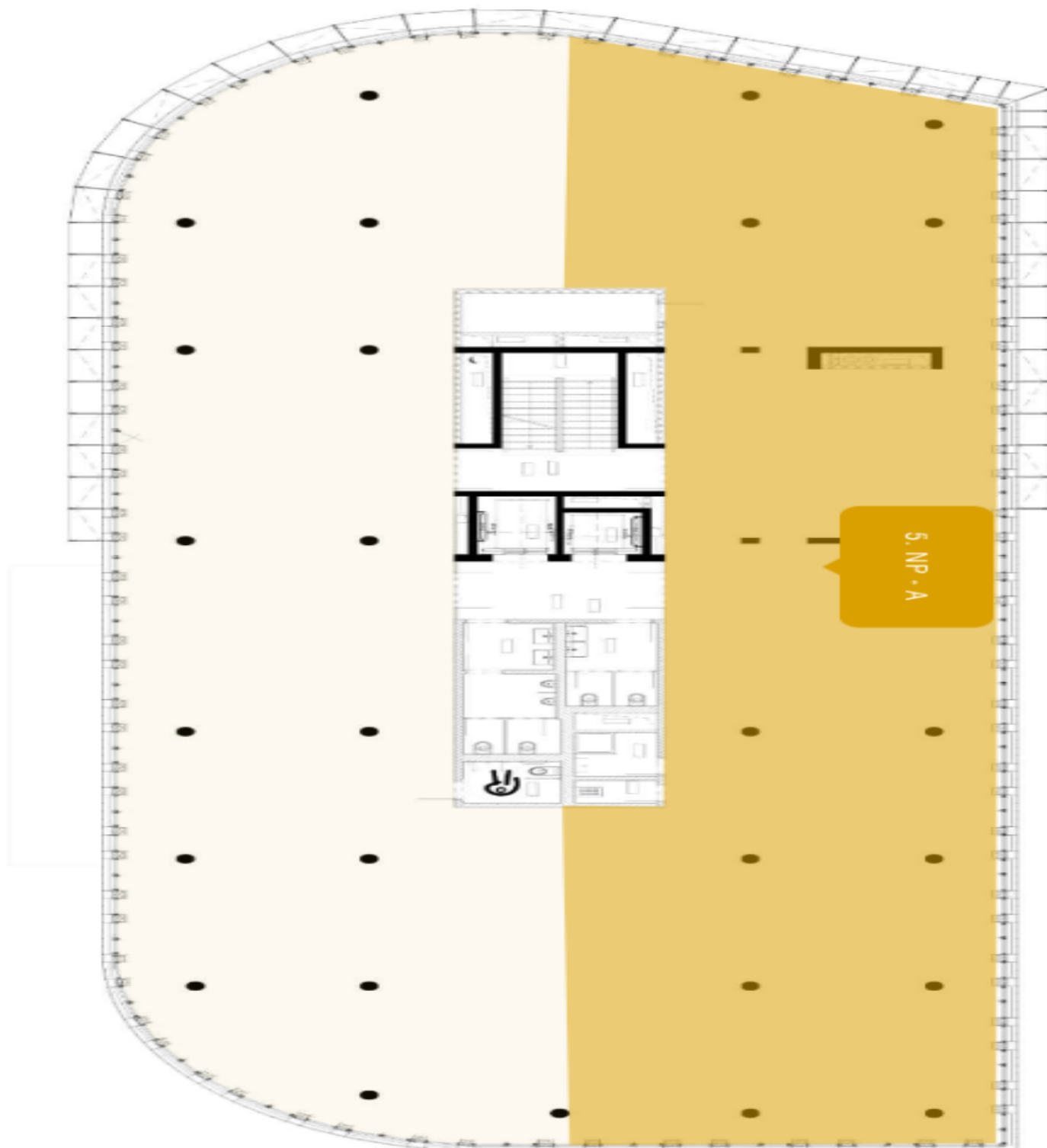

## Office space

Prague 8, Karlín, Křižíkova

Rented

