

## Office space

Rented

Prague 7, Holešovice, Dukelských hrdinů

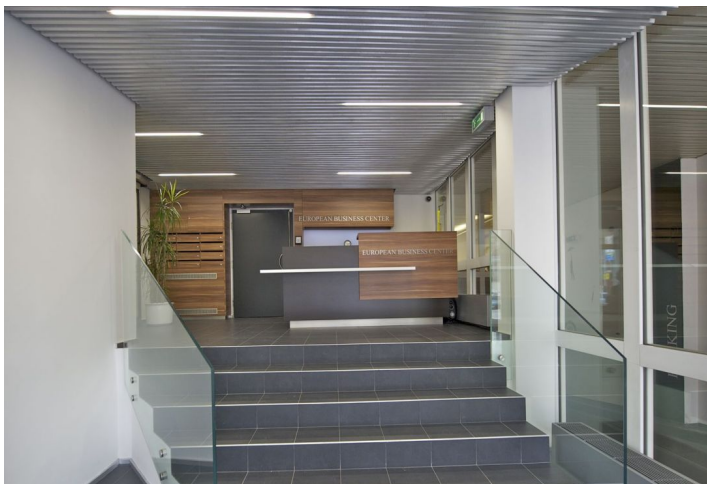

## Office space

Rented

Prague 7, Holešovice, Dukelských hrdinů

Service price	115 CZK monthly per m <sup>2</sup>
Available area	289 m <sup>2</sup>
Cellar	-
Parking	EUR 100 / pp / month
PENB	G
Reference number	39273

Office space for lease in a building with a historic facade opposite the Veletržní palác. The building has 2 elevators, a representative entrance hall, a courtyard, air conditioning, smoke detectors, 24-hour reception and security. These are spaces with their own indoor terrace. There are also two kitchens, including equipment, private bathroom and shower.

**Location:**

Great accessibility by public transport. Tram stop Veletržní palác is right next to the building, and the Nádraží Holešovice metro station (line C) and the Prague-Bubny train station are within an 8-minute walk.

**Features and Services:**

- 2 lifts
- Representative entrance hall
- Yard with greenery
- Air conditioning
- Modern telecommunication system
- Smoke detectors
- Modern office lighting
- 24-hour reception and security

Rental and service charges listed without VAT. Lessee pays no commission.

