

Office space

Rented

Prague 4, Michle, Za Brumlovkou

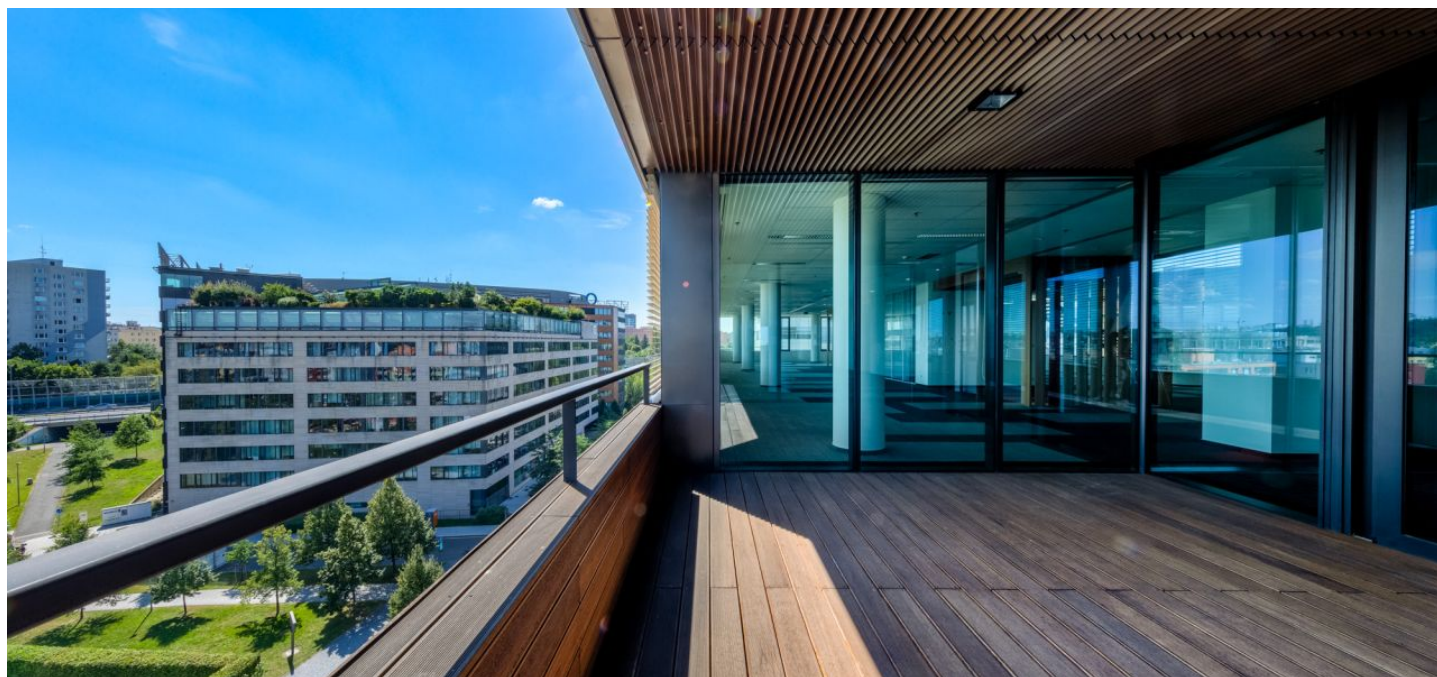

Office space

Rented

Prague 4, Michle, Za Brumlovkou

Service price	151 CZK monthly per m ²
Available area	1 243 m ²
Cellar	-
Parking	EUR 125 / ps / month
PENB	C
Reference number	37091

Office premises for lease on the 6th floor of an administrative complex located in the southeastern part of the BB Centrum, between Vyskočilova and Sedláčková streets. The office space is fully equipped.

Location:

Excellent access by car and public transport – strategically situated near the D1 highway and the Prague Ring Road, a shuttle bus connects the building and the Kačerov and Budějovická metro stations (line C).

Features and services:

Raised floors, floor boxes, a suspended ceiling with integrated lighting, air conditioning – chilled beams, a sprinkler system, two separate entrances with elegant lobbies, 24/7 access and security, a canteen, ideal as a client center or showroom on the ground floor, a sign on the building, openable windows. With green rooftop terraces; green areas surround the building.

Rental and service charges are listed without VAT. Lessee pays no commission.

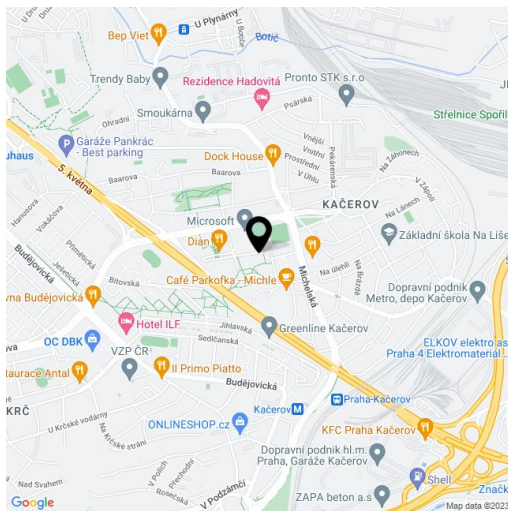

Prague 4, Michle, Za Brumlovkou

6. patro / 6th floor

PROSTORY NAJEMCE / TENANT'S PREMISES: 1155,6 m²
Čistá plocha / Net Office Area: 1098 m²
Shared Area / Shared Premises: 57,6 m²

DELTA II

- SPOLÉČNÉ PROSTORY / COMMON AREA
- SOCIÁLNÍ ZÁSTĚNA + KUCHYŇKY / RESTROOMS + KITCHEN

DELTA I

- SPOLÉČNÉ PROSTORY / COMMON AREA
- SOCIÁLNÍ ZÁSTĚNA + KUCHYŇKY / RESTROOMS + KITCHEN
- TERASA / TERRACE

