

## Apartment One-bedroom (2+1)

Rented

79 m<sup>2</sup>, Prague 2, Vinohrady, Polská



## Apartment One-bedroom (2+1)

Rented

79 m<sup>2</sup>, Prague 2, Vinohrady, Polská

Total area	79 m <sup>2</sup>
Parking	-
Cellar	Yes
Service price	Monthly services and water CZK 3,153, electricity and gas - transferred to the tenant.
PENB	E
Reference number	34841
Available from	Immediately

This furnished apartment is on the 3rd floor of a renovated Art Nouveau building with an elevator and preserved original features. Located on a quiet street on the edge of lovely Riegrovy Sady Park, a few blocks from the Jiřího z Poděbrad metro station, with very quick access to the city center. Full amenities are available within easy reach, incl. many fine restaurants, trendy bistros, cafes, and a popular farmers' market.

The apartment features a living room with a functional tile stove and views of the adjacent park, a fully fitted kitchen, a separate bedroom, a bathroom with a shower and 2 sinks, a utility room, a separate toilet, and an entrance hall.

Preserved original details, high ceilings, hardwood floors, tiles, built-in wardrobes, washer, dishwasher, microwave oven, dishes, cellar.

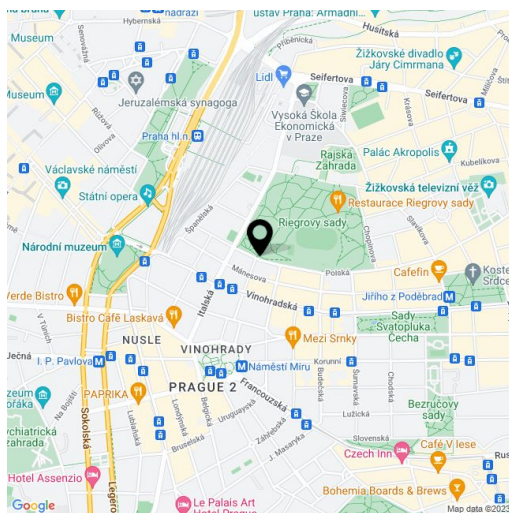

\* Size of the unit according to the Housing Act.  
The area consists of the sum total of the internal area of every room.

## Apartment One-bedroom (2+1)

Rented

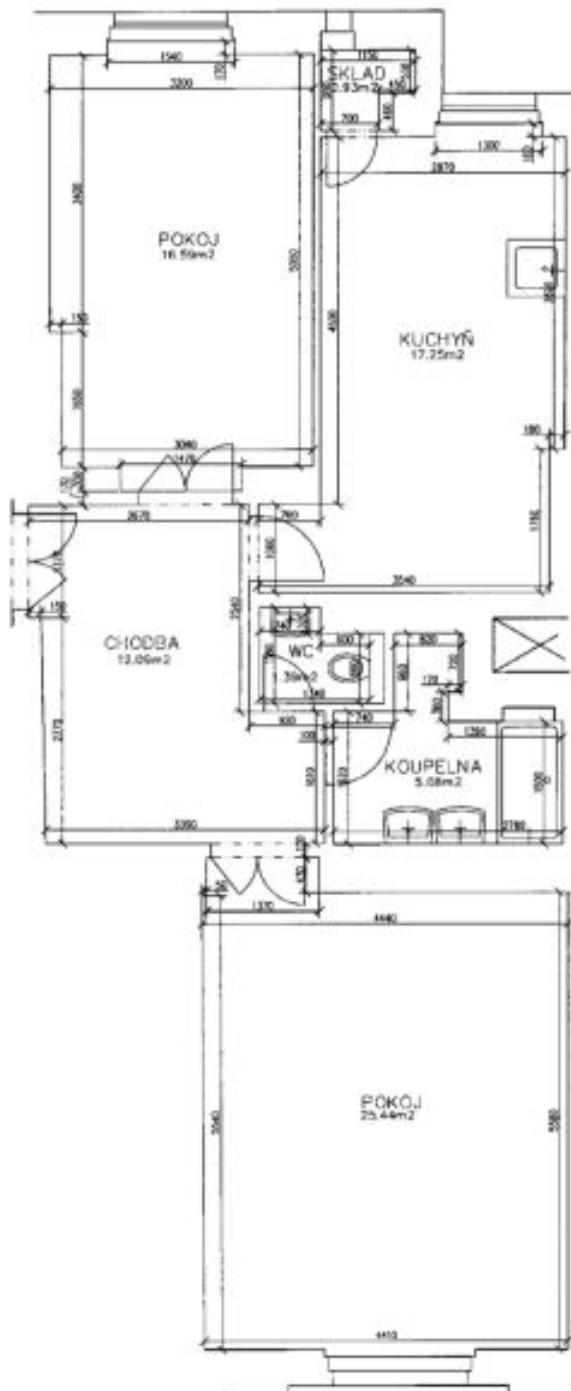
79 m<sup>2</sup>, Prague 2, Vinohrady, Polská

MÍSTNOST	PLOCHA(m2)
Chodba	12.09
Sklad	0.93
WC	1.39
Koupeľna	5.08
Kuchyň	17.25
Pokoj	16.59
Pokoj	25.44
<b>Celkem</b>	<b>78.77</b>
sklepní kóje č.11	2.38