

## House Six-bedroom (7+1)

Rented

330 m<sup>2</sup>, Prague 4, Lhotka, K Novému dvoru



# House Six-bedroom (7+1)

**Rented**330 m<sup>2</sup>, Prague 4, Lhotka, K Novému dvoru

Plot	600 m <sup>2</sup>
Parking	Garage.
Garage	Yes
Cellar	Yes
PENB	B
Reference number	27380
Available from	Immediately

This fully refurbished historic villa used to be a home of the world-renowned composer Antonín Dvořák. Newly completely renovated 6-bedroom 4-bathroom free standing house with a garden in a quiet tree lined street in a residential neighborhood in Lhotka, Prague 4. Location with lots of greenery and bus connections to Kačerov metro station, line C. Within easy reach of full amenities incl. a kindergarten within walking distance, and convenient to the Prague British School, the English International School Prague and the Austrian School.

Ground floor: living room with dining area and an electric fireplace, fully fitted kitchen with storage room accessible from the garage, study / guest bedroom, guest toilet, entrance hall with built-in storage, back entrance to a large covered terrace. First floor: master bedroom with a fitted walk-in closet and en-suite shower bathroom, three more bedrooms - one is walk-through, one more en-suite shower bathroom, family bathroom (bath). Second floor: large open attic gallery suitable for a playroom, walk-in closet, one bedroom, shower bathroom. Basement floor (nicely finished): two spacious rooms (fitness room, playroom,...), storage room / workroom with utility area.

Wooden floors, tiles, security entry door, automatic outdoor blinds, built-in wardrobes, gas boiler, dishwasher, induction cooktop, video entry phone, barbecue point in the garden. Garage plus parking on the plot. Utilities are billed separately.

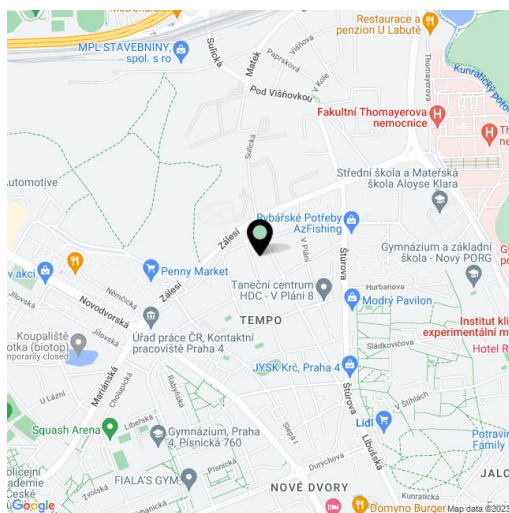

# House Six-bedroom (7+1)

Rented

330 m<sup>2</sup>, Prague 4, Lhotka, K Novému dvoru

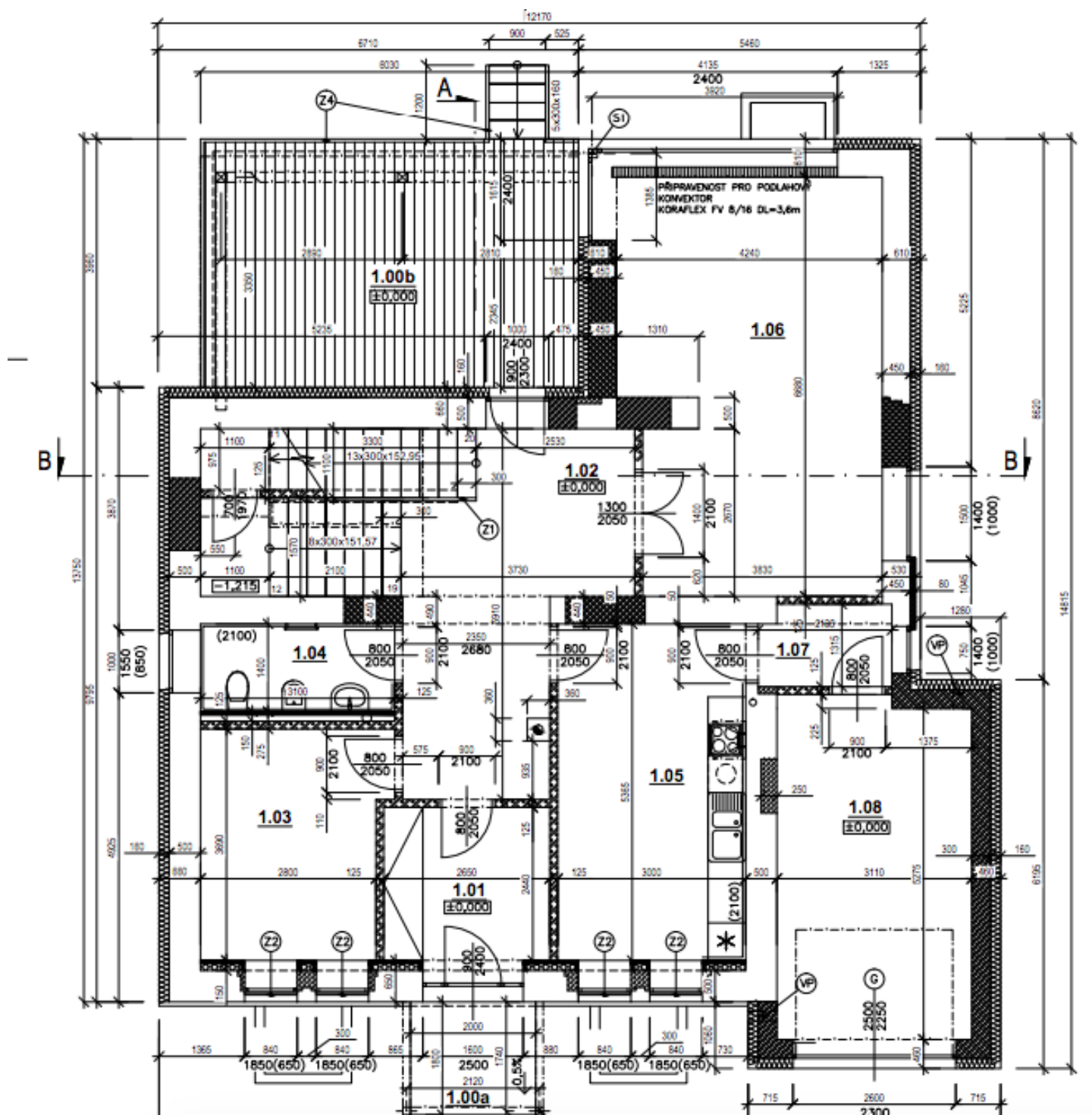

# House Six-bedroom (7+1)

Rented

330 m<sup>2</sup>, Prague 4, Lhotka, K Novému dvoru

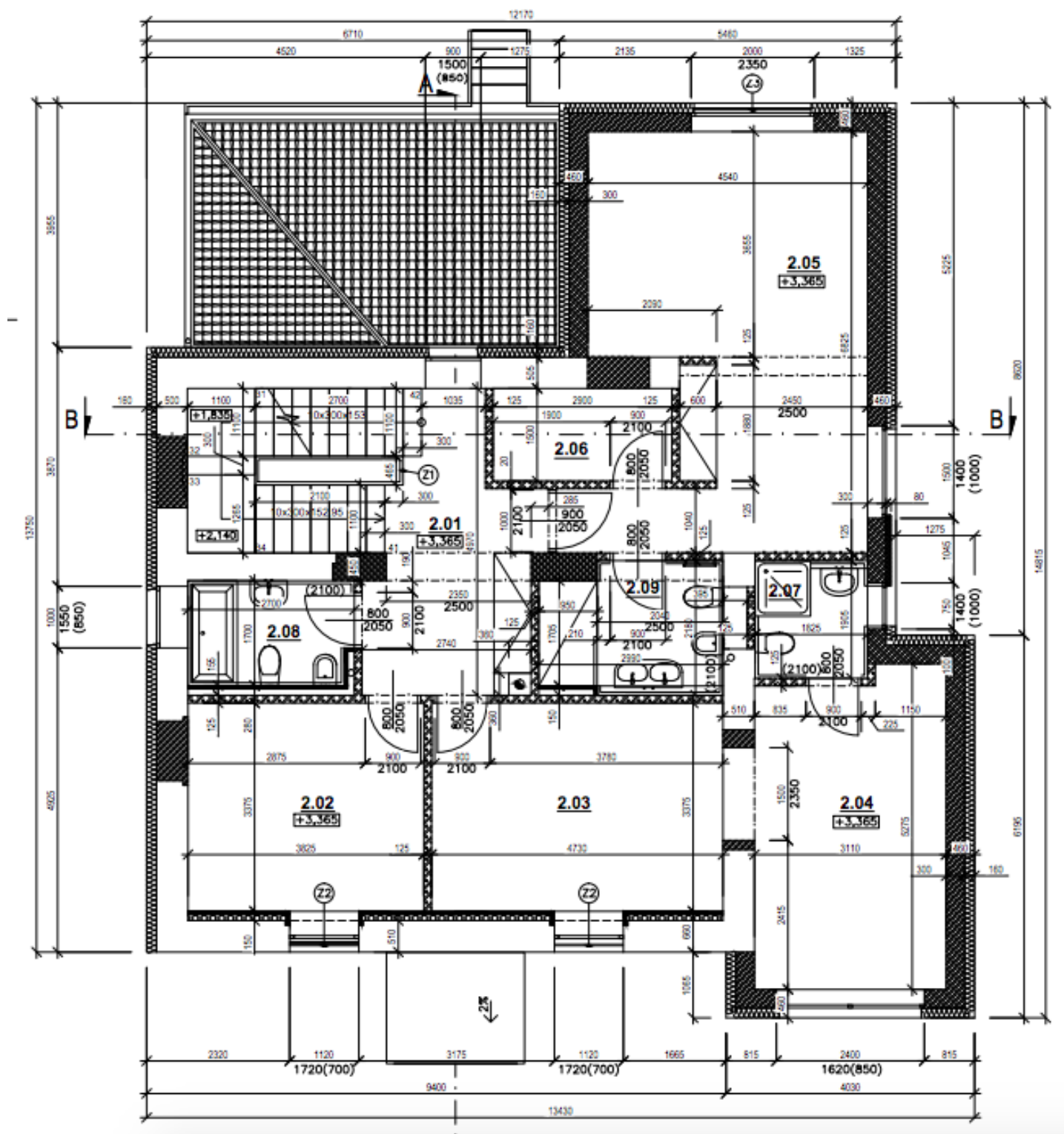

# House Six-bedroom (7+1)

Rented

330 m<sup>2</sup>, Prague 4, Lhotka, K Novému dvoru

