



Apartment Two-bedroom (3+kk)

Rented

71 m², Prague 2, Vinohrady, Na Švihance





Apartment Two-bedroom (3+kk)

Rented

71 m², Prague 2, Vinohrady, Na Švihance

Total area	71 m ²
Parking	-
Cellar	-
PENB	G
Reference number	24815
Available from	Immediately

Benefiting from a wonderful location next to the Riegrovy sady park, this is a fully refurbished unfurnished 2-bedroom flat on the third floor of a renovated residential building with lift. Very quick access to the city center, located just a short walk from Jiřího z Poděbrad Square with metro station, rich amenities and a very popular regular produce market.

The interior includes living room with a fully fitted open kitchen, two bedrooms, bathroom with bath, sink and toilet, pantry / storage room, and entry hall.

Preserved original details, **high ceilings**, solid wood **parquet** and vinyl **floors**, tiles, security entry door, gas heating, dishwasher, camera system. Monthly deposit for common building charges, water and heating CZK 3000/month. Electricity is billed separately (transfer to the tenant). **UNFURNISHED** despite the photos.

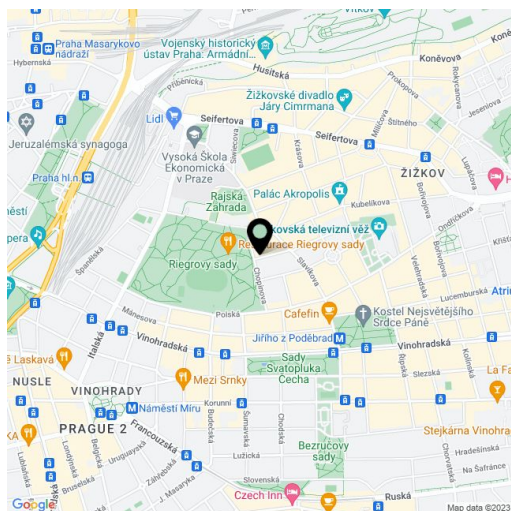

* Area of the unit according to the Civil Code. The area consists of the sum total area of the entire unit bounded by perimeter walls.



Apartment Two-bedroom (3+kk)

Rented

71 m², Prague 2, Vinohrady, Na Švihance

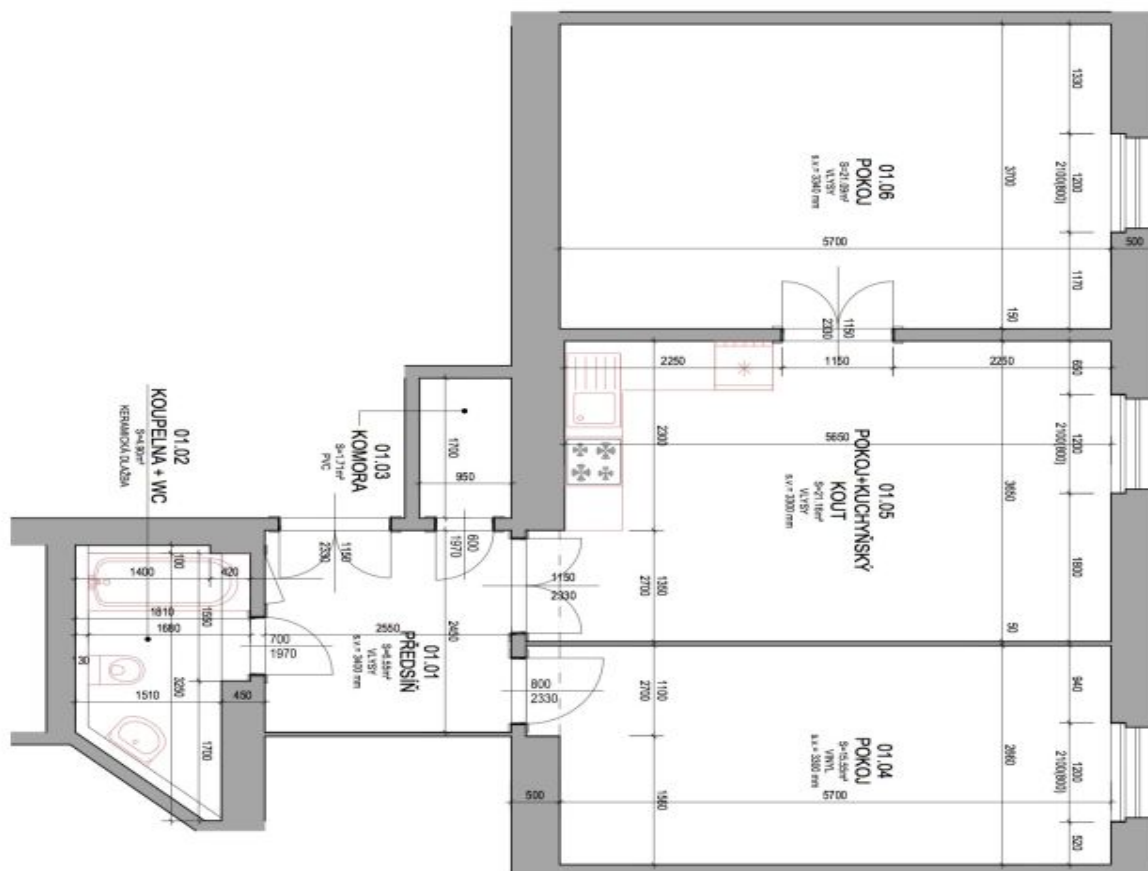

TABUĽKA MIESTNOSTÍ - NAVRHI				
ČÍSLO	NAZEV	PLOCHA [m ²]	PODLAHA	STĚNY
1.01	PŘEDSÍŇ	6,56	V. VYSV	VYNÁLEBA
1.02	KOUPELNA + WC	4,80	KERAMICKÁ DLAŽBA	KERAMICKÝ OBRUBOJ
1.03	KOMORA	1,71	PVC	VYNÁLEBA
1.04	POKOJ	15,55	VINT.	VYNÁLEBA
1.05	POKOJ + KUCHYŇSKÝ KOUT	21,18	V. VYSV	VYNÁLEBA
1.06	POKOJ	21,09	V. VYSV	VYNÁLEBA
	CELKEM	70,8515		