

## House Seven-bedroom (8+1)

Rented

378 m<sup>2</sup>, Prague 6, Nebušice, Nebušická



# House Seven-bedroom (8+1)

**Rented**378 m<sup>2</sup>, Prague 6, Nebušice, Nebušická

Total area	378 m <sup>2</sup>
Plot	486 m <sup>2</sup>
Foot print	143 m <sup>2</sup>
Garden	343 m <sup>2</sup>
Floor area	346 m <sup>2</sup>
Terrace	32 m <sup>2</sup>
Parking	Double garage.
Garage	Yes
Cellar	-
Service price	Utilities CZK 15,000 per month are billed separately.
PENB	B
Reference number	22377
Available from	01.07.2026

**Luxury unfurnished family house with a garden surrounded by green hills and a peaceful countryside, within walking distance of the ISP international school. Quick access to the city center, the airport, and international schools in Prague 6, convenient to the Bořislavka metro station (line A), and full amenities around the Dejvická metro station.**

Ground floor: spacious living room with a dining area and terrace/garden access, fully fitted kitchen with a pantry, guest toilet, entry hall with built-in wardrobes. First floor: three bedrooms, three en-suite bathrooms. Second floor: two bedrooms, two en-suite bathrooms and large walk-in closets, terrace. Basement: second living room/playroom, one bedroom, bathroom, laundry room, storage, garage, and garden access.

Green views, air-conditioning, hardwood floors, heated tiles, built-in wardrobes, blinds, washer, dryer, satellite TV connection, alarm, garden shed. Double garage. Unfurnished.

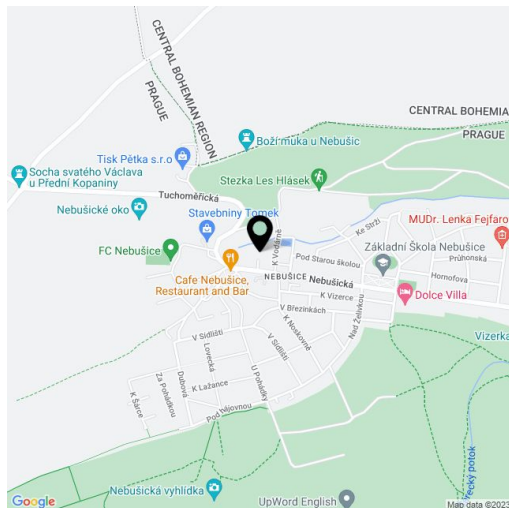



# House Seven-bedroom (8+1)

378 m<sup>2</sup>, Prague 6, Nebušice, Nebušická

Rented

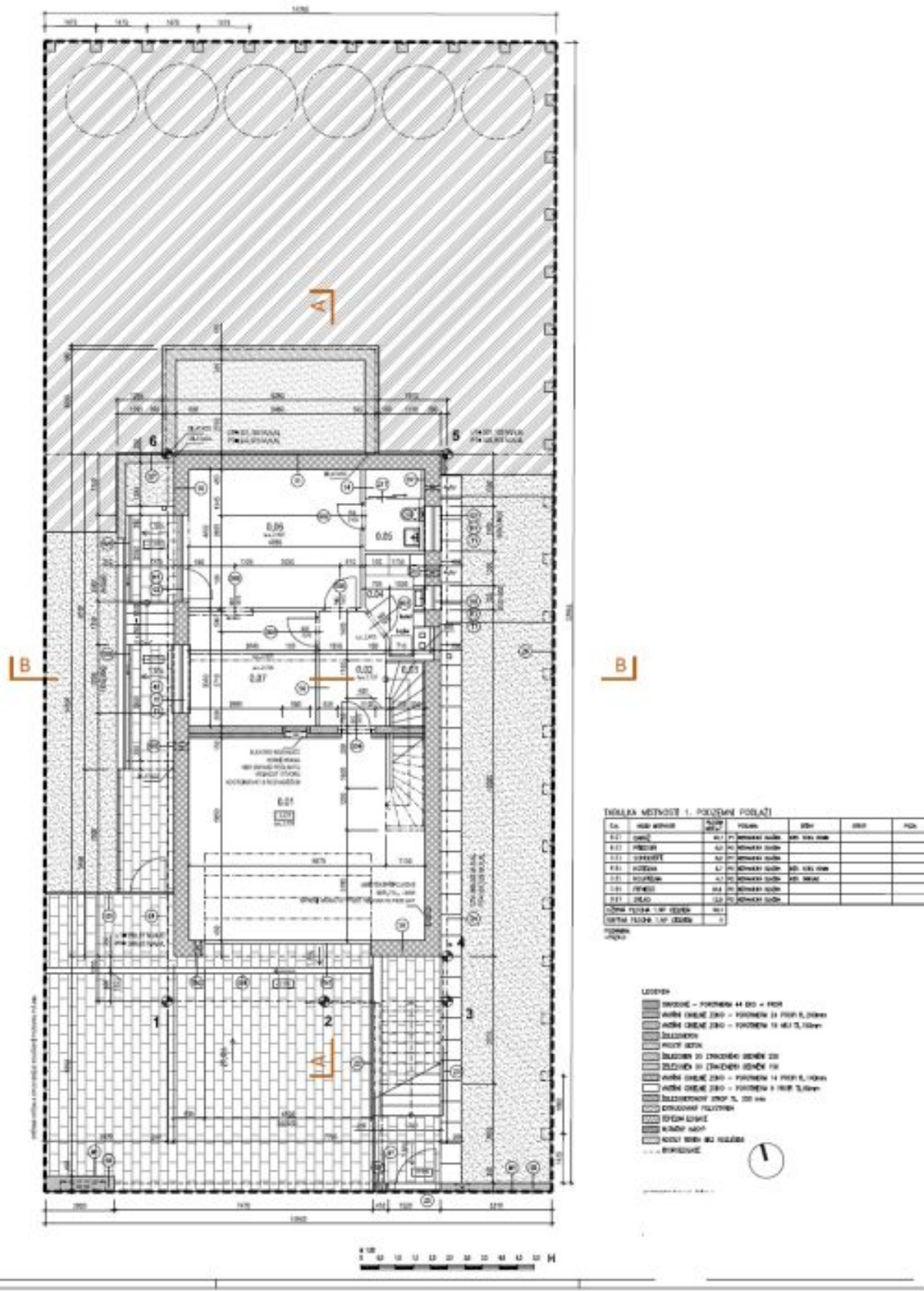







# House Seven-bedroom (8+1)

Rented

378 m<sup>2</sup>, Prague 6, Nebušice, Nebušická

