

Land

Sold

7 156 m<sup>2</sup>, Prague 6, Dejvice, U Vizerky



## Land

Sold

7 156 m<sup>2</sup>, Prague 6, Dejvice, U Vizerky

Price per sq. m.	2 515 CZK
Total area	7 156 m <sup>2</sup>
Land type	Housing
Reference number	17059

**Large plot of land for sale, situated in the unique location of Šárecké údolí Valley, close to attractive locations such as Hanspaulka and Nebušice, with quick access to both the airport and city center.**

There is a planning decision and valid building permit for the land with the possibility of building a house with a swimming pool. The project documentation is included in the purchase price.

Visual study of potential house has been prepared by architects from studio de.fakto.

The land can be divided into two separate land parcels.

Total area 7 156 m<sup>2</sup>.

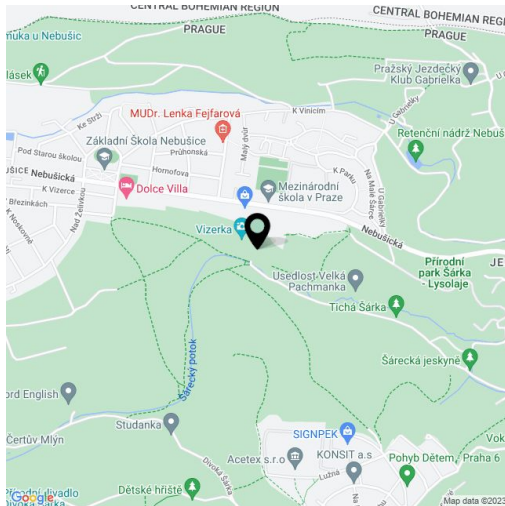

Land

Sold

7 156 m<sup>2</sup>, Prague 6, Dejvice, U Vizerky

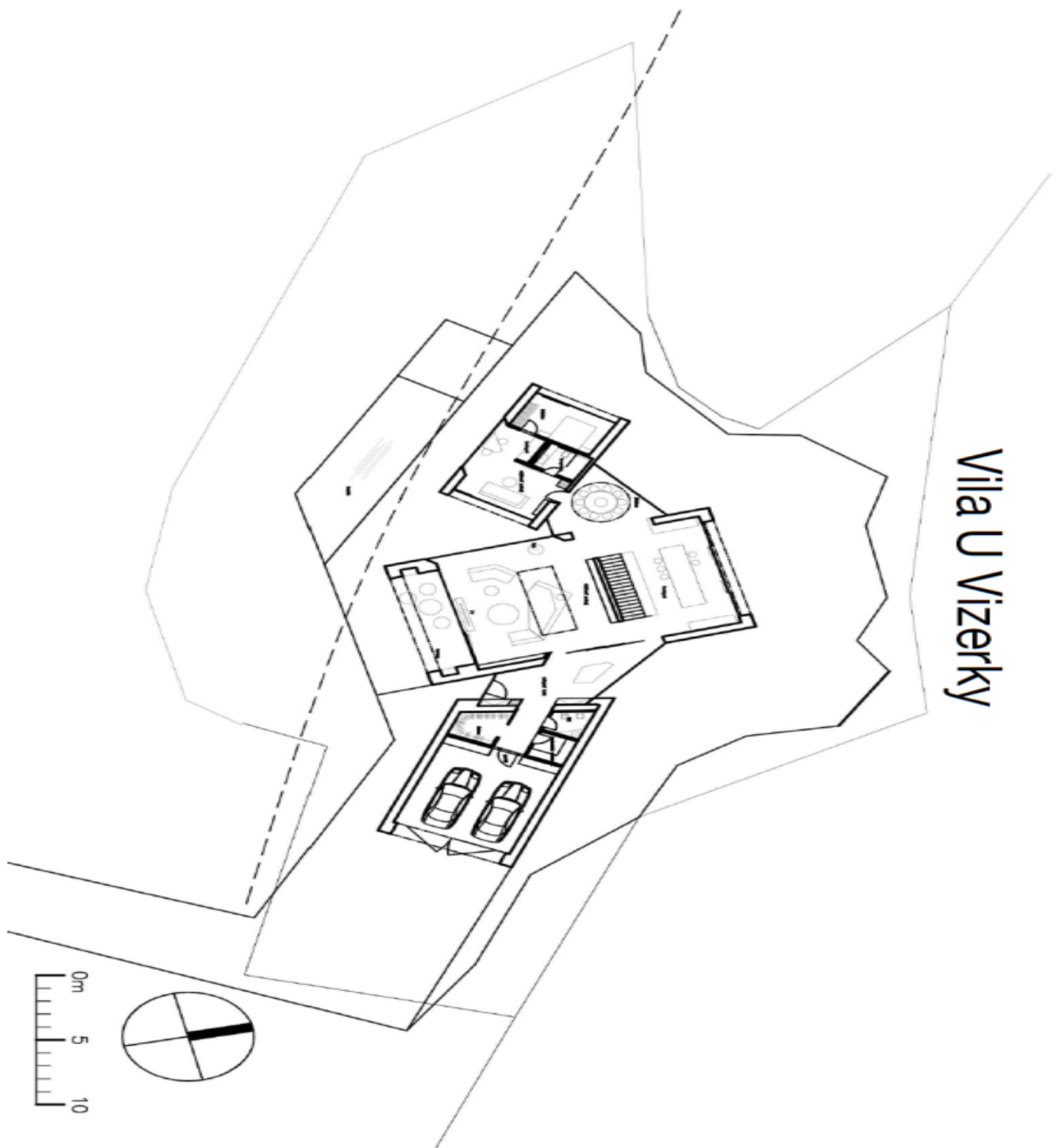

Land

Sold

7 156 m<sup>2</sup>, Prague 6, Dejvice, U Vizerky

