

Office building

€ 16.50 / m² | CZK 413 / m²

1453 m², Prague 4, Michle, Vyskočilova

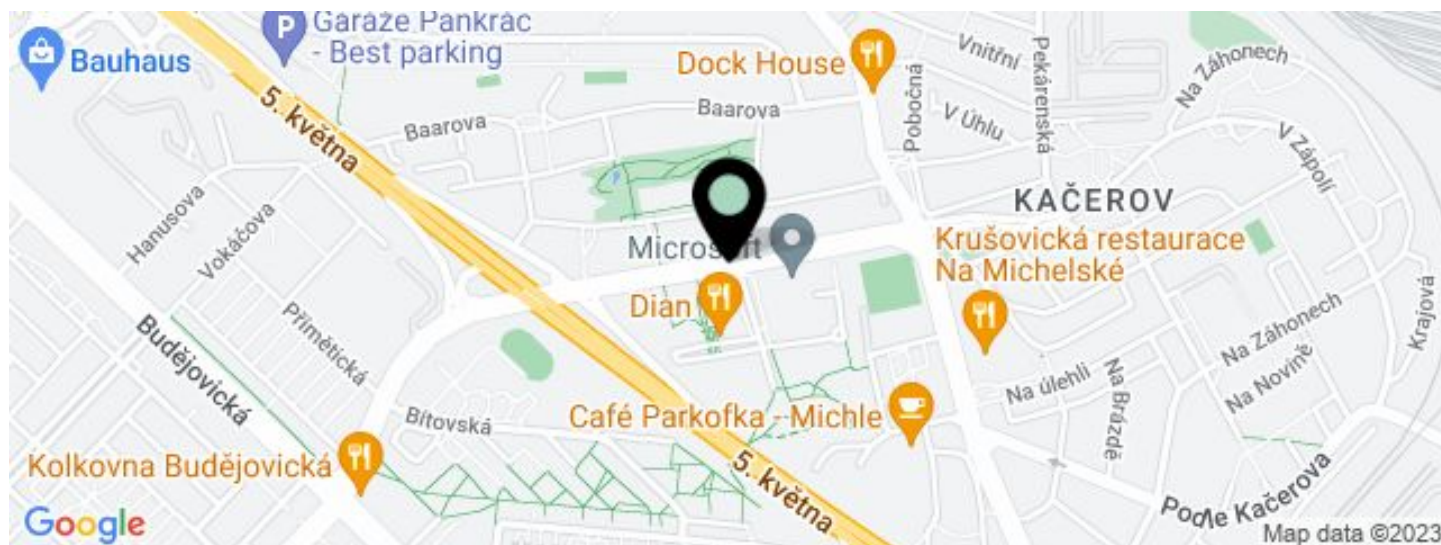

Office building

€ 16.50 / m² | CZK 413 / m²1 453 m², Prague 4, Michle, Vyskočilova

UNIT	AVAILABLE AREA	SERVICES	PARKING	MONTHLY RENT
Sublease, Office space, 3rd floor	2 050 m ²	204 249 CZK monthly	Yes	€ 16.50 / m ²
Office space, 2nd floor	443 - 1 105 m ²	110 CZK monthly per m ²	EUR 115 / ps / month	€ 16.50 / m ²
Office space, 1st floor	348 m ²	110 CZK monthly per m ²	EUR 115 / ps / month	€ 16.50 / m ²

Office building

€ 16.50 / m² | CZK 413 / m²1 453 m², Prague 4, Michle, Vyskočilova

Service price	110 CZK monthly per m ²
Total building area	11 613 m ²
Tenant consumption	—
Parking	115 EUR
Parking service charges	—
Parking ratio	—
Certification	—
PENB	A
Reference number	16919

Administrative building with office space for lease situated in the business district of Prague 4, designed by Czech architect Jan Aulík. The seven-storey building offers more than 12,000 m² of high-quality office and retail space and ample underground parking.

Location:

Very good accessibility by car and public transport – Budějovická and Kačerov metro stations (line C) are just 2 minutes by bus or 8 minutes on foot. A shuttle bus connects the building with the metro stations. Easy access to Prague's city ring and to the D1 highway leading to Brno.

Features and Services:

24/7 Access
Access Control
Air Conditioning
Can be divided
Flexible floorplan
Floorplan greater than 2000 sqm
Green Certification
Monitoring
Openable Windows
Outdoor shaders
Parking
Raised Floor
Reception
Security
Ventilation

Rental and service charges listed without VAT. Lessee pays no commission.

1. PATRO

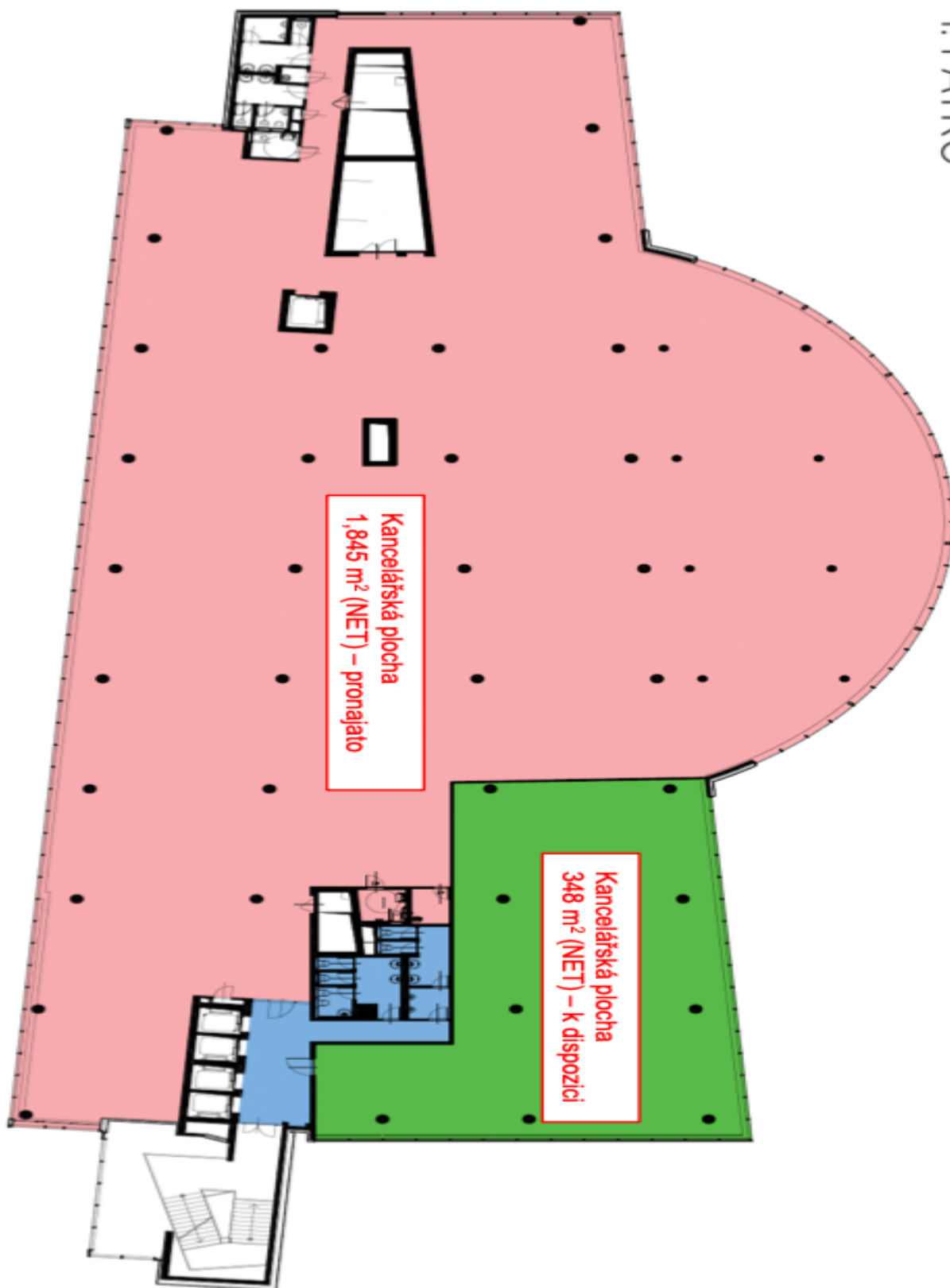

2. PATRO

