

Office building

Rented

Prague 5, Smíchov, Karla Engliše

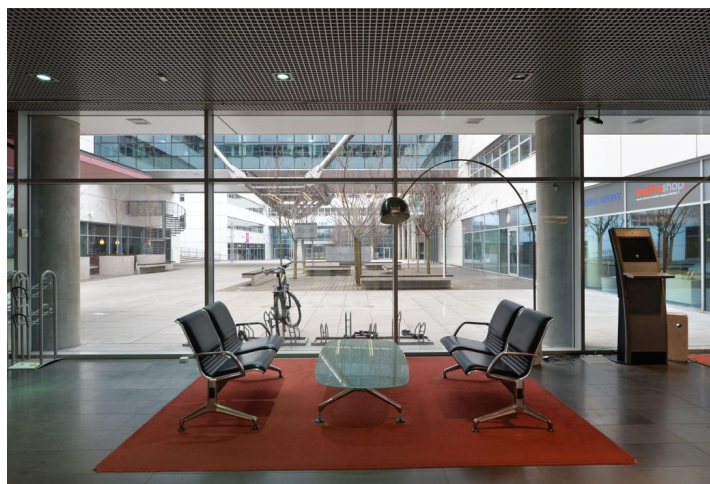

Office building

Rented

Prague 5, Smíchov, Karla Engliše

Service price	5 EUR monthly per m ²
Total building area	14 362 m ²
Tenant consumption	—
Parking	125 EUR
Parking service charges	—
Parking ratio	—
Certification	—
PENB	G
Reference number	16786

Administrative office building with office premises for lease situated in Prague 5, moments from the Anděl commercial and entertainment center.

Outdoor common areas such as inner courtyard and other attractive exterior elements. Building has garage parking.

Location:

Very good accessibility by car and public transport – the building is located within walking distance of Plzeňská Street, in close proximity to tram and bus stops and the Anděl metro station (line B).

Features and Services:

Reception desk
Open space layout
Air-conditioning
External blinds
Suspended ceilings with light fittings
Raised floors and carpets

Rental and service charges listed without VAT. Lessee pays no commission.

Office building

Prague 5, Smíchov, Karla Engliše

Rented

