



## Retail space

43 m<sup>2</sup>, Prague 1, Malá Strana, Míšeňská

Sold





## Retail space

43 m<sup>2</sup>, Prague 1, Malá Strana, Míšeňská

**Sold**

Total area	43 m <sup>2</sup>
Parking	-
PENB	G
Reference number	15444

Newly reconstructed retail space with lots of light in the attractive location of Lesser Town. Interior 42.96 m<sup>2</sup>, Ground floor. The space is offered completed in high standard of materials and finishings.

Original historic features preserved: vaulted ceilings, wooden tread floor, landing and front door, all which creates an unique atmosphere. In combination with modern technology units meets the requirements for functional business space.

Situated in the most beautiful part of Prague, the Lesser Town, minutes from tram and metro stations, in an area with full public amenities and within easy reach of the Charles Bridge, Malostranské náměstí Square, Kampa, Klárov or the Wallenstein Gardens. The ideal combination for operating of a cafe, wine shop, gallery or an office.

**Rented until May 2018 with monthly income of CZK 32 370.**

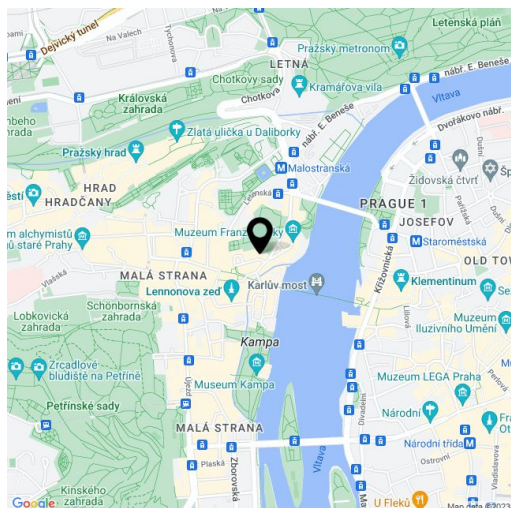



## Retail space

43 m<sup>2</sup>, Prague 1, Malá Strana, Míšeňská

Sold

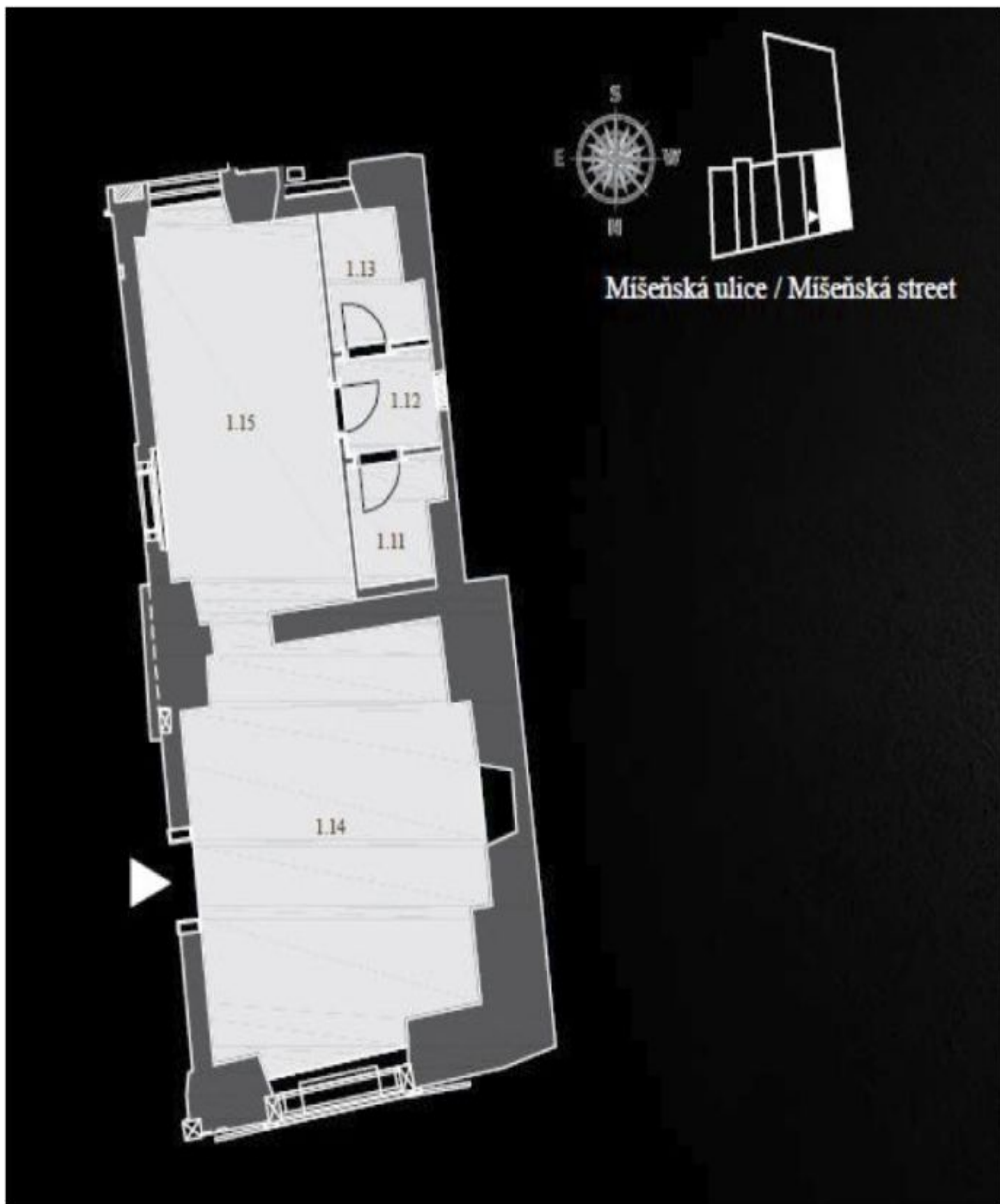



## TABULKA VÝMĚR

č.místn.	účel	m <sup>2</sup>
1.11	WC	2,00
1.12	předsín	2,00
1.13	úklidová místnost	2,20
1,14	prodejní plocha	22,60
1.15	prodejní plocha	14,50
<b>CELKEM:</b>		<b>43,30</b>



## Retail space

43 m<sup>2</sup>, Prague 1, Malá Strana, Míšeňská

Sold

