

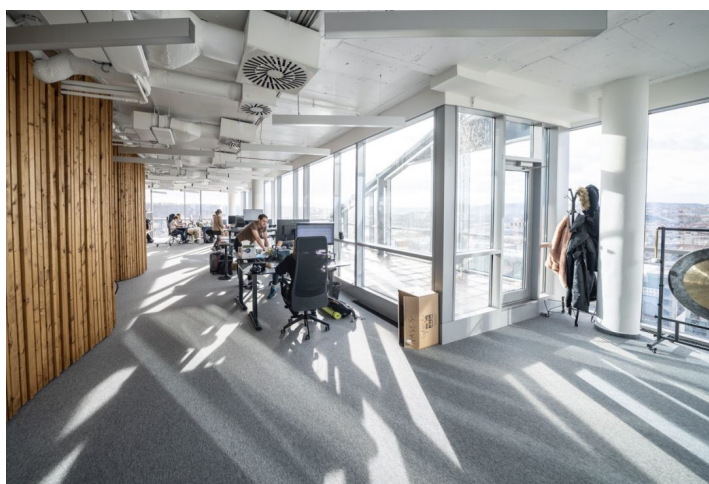

Office space

€ 13.50 / m² | CZK 337 / m²

Prague 7, Holešovice, Jankovcova

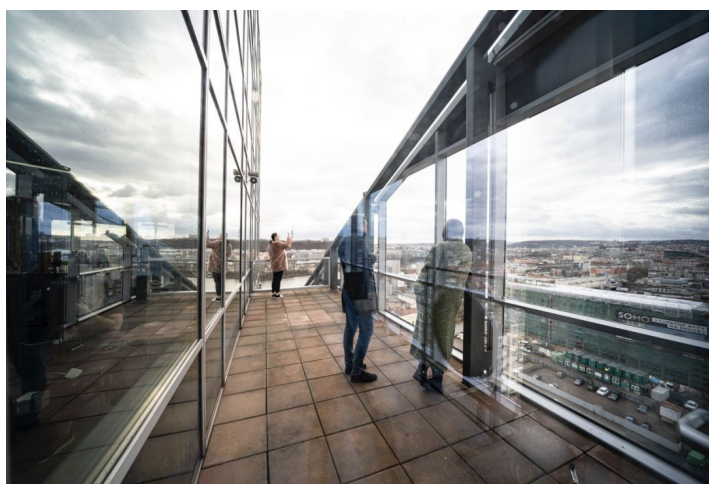
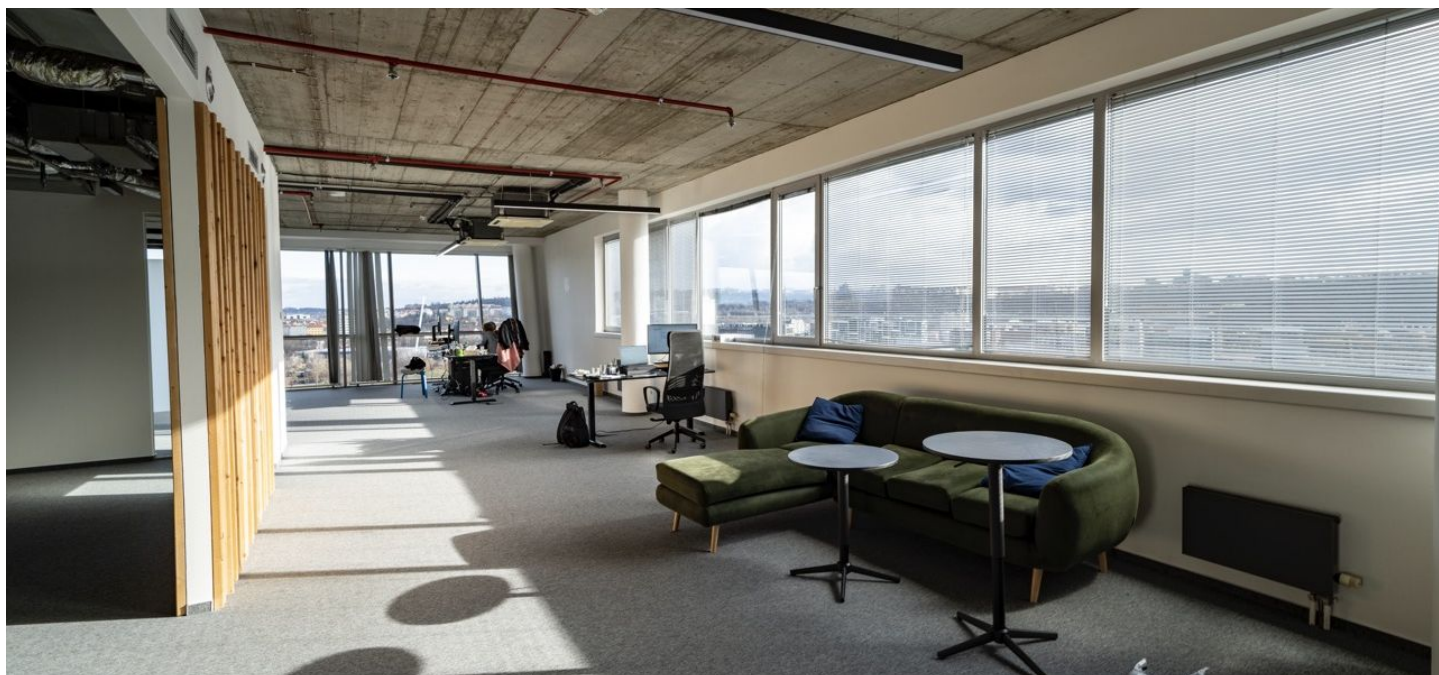



Office space

Prague 7, Holešovice, Jankovcova

€ 13.50 / m² | CZK 337 / m²

Service price	135 CZK monthly per m ²
Available area	550 m ²
Cellar	-
Parking	EUR 110 / ps / month - parking service charges 250 CZK
PENB	Not required
Reference number	107187

Modern office space for sublease until 30 June 2028 on the 13th floor situated in an office building on the right bank of the Vltava River in Holešovice. The space can be subleased with or without furniture, with or without a shared reception, and with the possibility of including a cleaning service. Electricity consumption is paid on the basis of monthly deposits of CZK 6,000 with annual billing. The deposit is equivalent to two months' rent and running costs.

The total area of the office is 1 018 sq. m, only one or the other half is available, depending on preference. Both halves have an area between 500 sq. m and 550 sq. m.

Location:

Great accessibility by public transport and by car - close to metro stations Vltavská (line C) and Palmovka (line B), and just a few minutes walk to tram stops Dělnická and Maniny.

Features and Services:

- Central reception
- 24-hour security service
- Air condition
- CCTV security system
- Modern elevators
- Warehouse space on the underground floors
- Underground garage parking
- Restaurant and café

Rental and service charges listed without VAT. Lessee pays no commission.

