

Office space

€ 14.90 - 15.90 / m<sup>2</sup> | CZK 373 - 398 / m<sup>2</sup>

Brno-město, Trnitá, Přízova

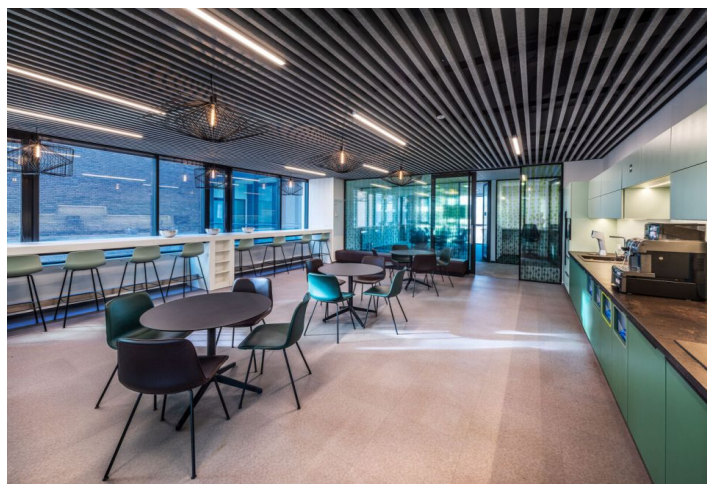



## Office space

€ 14.90 - 15.90 / m<sup>2</sup> | CZK 373 - 398 / m<sup>2</sup>

Brno-město, Trnitá, Přízova

Service price	4 EUR monthly per m <sup>2</sup>
Available area	667 m <sup>2</sup>
Cellar	-
Parking	Yes
PENB	G
Reference number	106153

Office space for lease on the 2nd floor in an administrative complex which is consisting of 9 office buildings built by BREEAM standards provides residents besides modern offices also relaxing park with a lake.

**Location:**

The great advantage of the project is the perfect public transport connection, the main bus and train station within walking distance and easy connection to the Brno ring road and the motorway network. The city center of Brno and the Vaňkovka shopping gallery, which are close by, guarantee the tenants all the civic amenities and services.

**Features and Services:**

- Double floors
- High-speed internet
- Rest park
- 24/7 facility guard
- Underground garage

Rental and service charges listed without VAT. Lessee pays no commission.

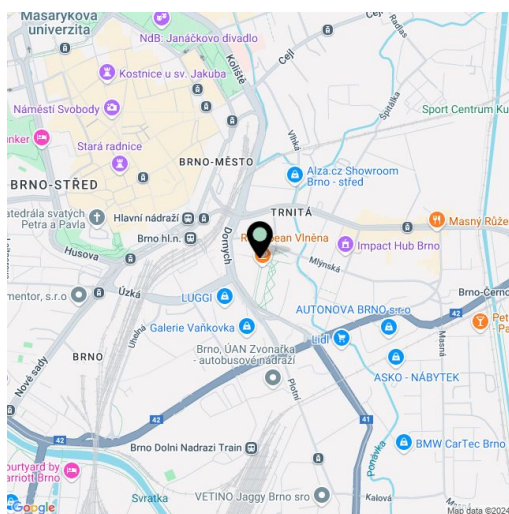

Office space

€ 14.90 - 15.90 / m<sup>2</sup> | CZK 373 - 398 / m<sup>2</sup>

Brno-město, Trnitá, Přízova



<b>BUILDING</b>	<b>H</b>
2 <sup>nd</sup> floor / 3 <sup>rd</sup> upper floor	
Office	667 m <sup>2</sup>
Sanitary	38 m <sup>2</sup>
Corridors	25 m <sup>2</sup>
<b>Total rentable area</b>	<b>730 m<sup>2</sup></b>

