



Warehouse space

1 393 m², Praha-východ, Čestlice, Obchodní

Ask for price





Warehouse space

1 393 m², Praha-východ, Čestlice, Obchodní

Ask for price

Total area	1 393 m ²
Available area for rent	1 393 m ²
Office area	294 m ²
Ceiling height	7 m
Floor loading capacity	5 t/m ²
Column grid structure	—
Structure	Reinforced concrete structure
PENB	C
Reference number	103888

Warehouse/showroom and office space for lease in the largest retail park in the Czech Republic, situated close to Prague. The premises consists of warehouse 780 sqm, showroom/office/warehouse ground floor 228 sqm, offices 1st floor 294 sqm, other premises 91 sqm.

Location:

The Průhonice-Čestlice retail park is located just outside the Prague city border on the D1 highway (Prague – Brno), between exit 6 and 8.

Features and Services:

- Property management
- Park maintenance
- 24 hours security, physical and electronic security
- Electric fire alarm
- 10 individual car parking places
- number of restaurants and shops in the vicinity

Warehouse/Retail premises:

- flexible space
- 1 loading door for trucks
- Clear height 7m
- Polished concrete floor 5t/m²
- Utility connections (water, sewage, gas, electricity)

Office:

- Air-conditioning
- Openable windows

Rental and service charges are listed without VAT. Lessee pays no commission.

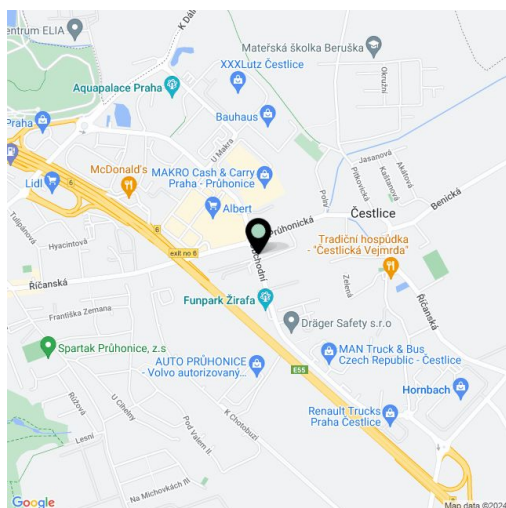



PŘÍZEMÍ

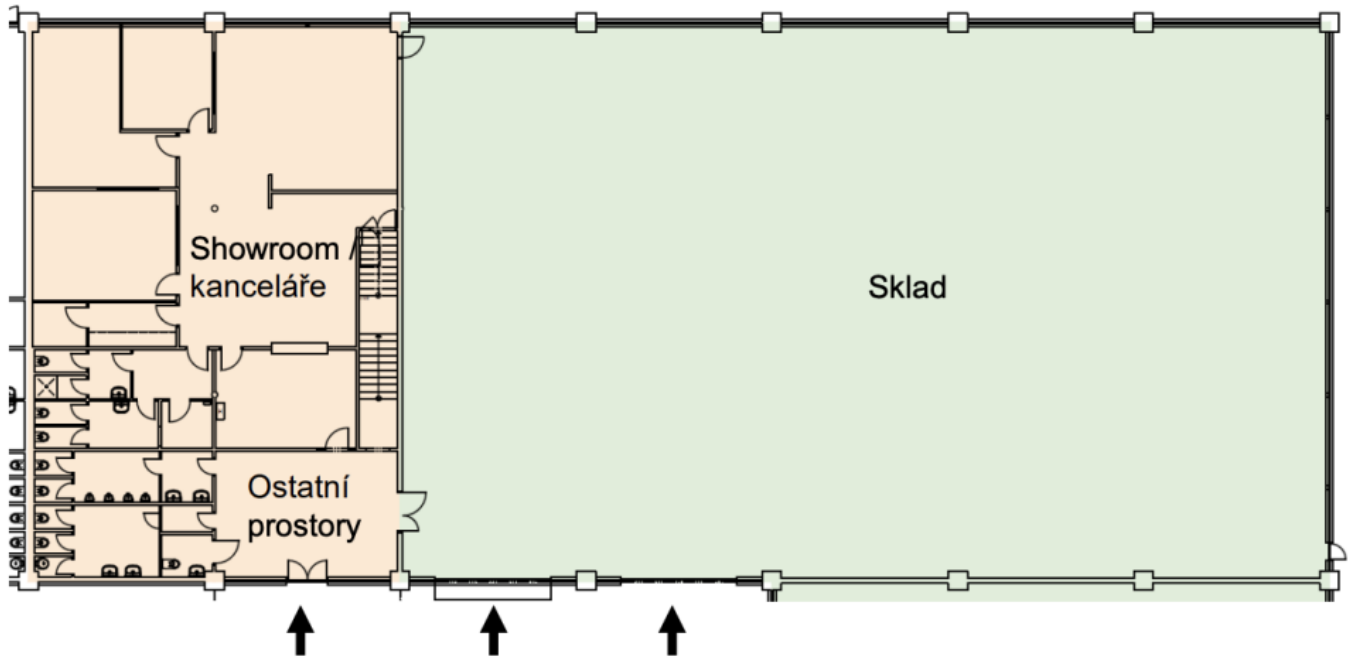

1. PATRO

