



Apartment One-bedroom (2+kk)

Sold

75 m², Prague 1, Josefov, Široká





Apartment One-bedroom (2+kk)

Sold75 m², Prague 1, Josefov, Široká

Total area	75 m ²
Parking	-
Cellar	Yes
PENB	G
Reference number	100904

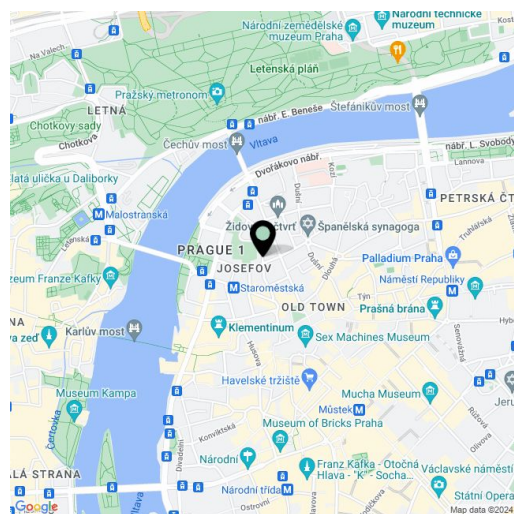

* Size of the unit according to the Housing Act.
The area consists of the sum total of the internal area of every room.

This refined apartment with large rooms, high ceilings, a bay window, air-conditioning, and an interior in subtle natural colors is located on the 3rd floor of a corner historic apartment building in an attractive area in Prague 1 – Josefov, close to Old Town Square and Pařížská Street.

The layout of the apartment includes a corner living room with a bay window and kitchen, a bedroom with a spacious walk-in wardrobe, a designer bathroom (with a shower), a separate toilet, a walk-in wardrobe, a laundry room, and a large entrance hall.

The apartment with ceilings over 3 m high was renovated in 2014. The high-quality facilities include air-conditioning, a home system, Miele appliances, built-in lighting and sound system, and built-in storage spaces. Large casement windows let in plenty of natural daylight, and the floors are parquet in a classic tree pattern. Heating is provided by a gas condensing boiler. The building has been completely and sensitively reconstructed. There is an elevator.

In addition to the breathtaking architecture, which attracts tourists from all over the world, the historic core of Prague also provides everything needed for everyday life. The neighborhood is full of quality restaurants, cafes and shops, theaters, and other places to go for culture. Excellent transport connections to all parts of Prague are provided by the nearby metro station and tram stop.

Floor area 75.1 m².



Apartment One-bedroom (2+kk)

75 m², Prague 1, Josefov, Široká

Sold

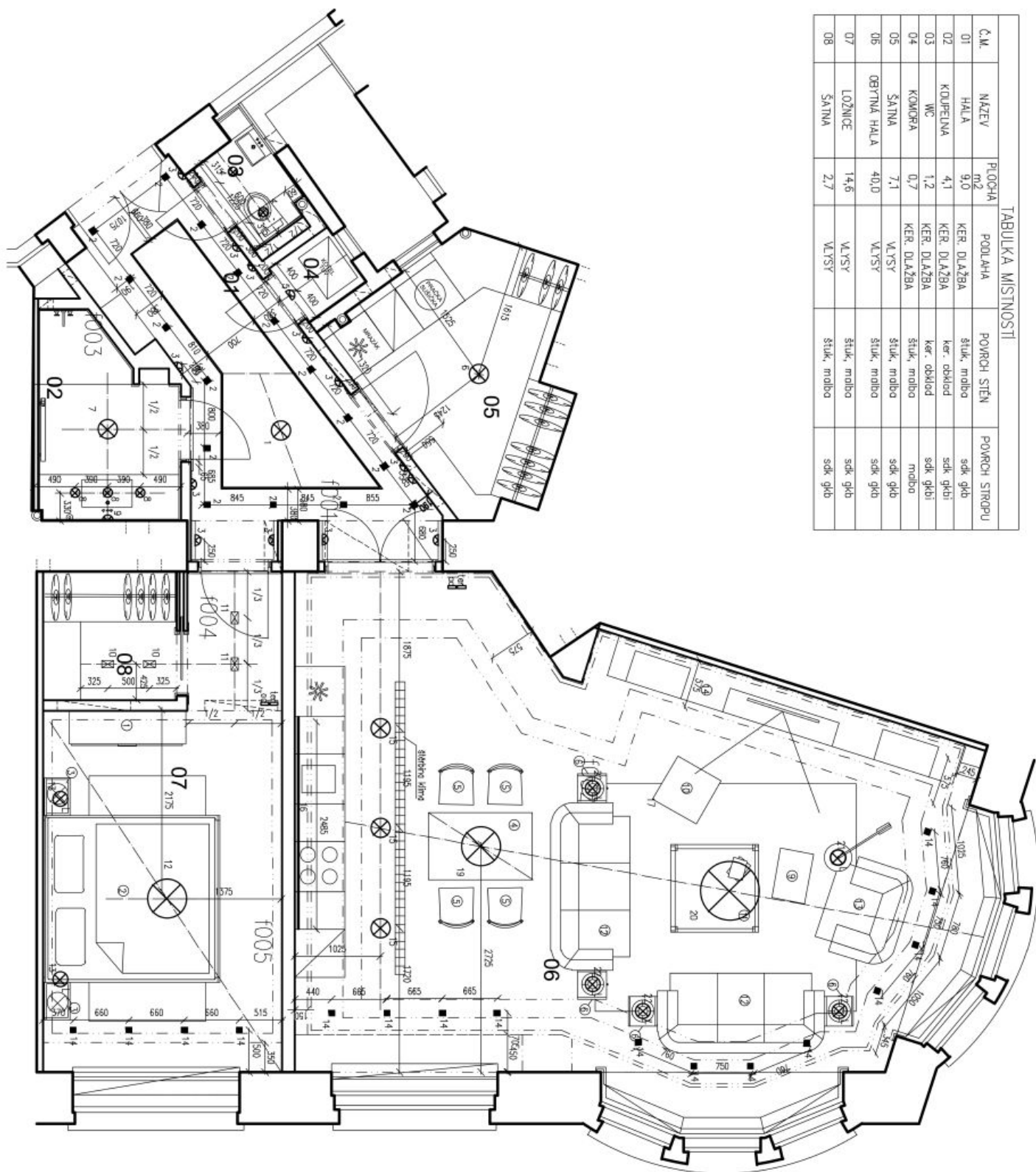

TABULKA MÍSTNOSTI					
Č.M.	NAZEV	PLOCHA m ²	PODLAHA	POVRCH STĚN	POVRCH STŘEPU
01	HAZEV HALA	9,0	KER. DLAŽBA	štuk, mořba	sdk, gfb
02	KUPELNA	4,1	KER. DLAŽBA	ker. obklad	sdk, gfb
03	WC	1,2	KER. DLAŽBA	ker. obklad	sdk, gfb
04	KOMORA	0,7	KER. DLAŽBA	štuk, mořba	mořba
05	ŠATNA	7,1	VĚVSY	štuk, mořba	sdk, gfb
06	OBÝTNÍ HALA	40,0	VĚVSY	štuk, mořba	sdk, gfb
07	LOŽNICE	14,6	VĚVSY	štuk, mořba	sdk, gfb
08	ŠATNA	2,7	VĚVSY	štuk, mořba	sdk, gfb